

CHINATOWN GATE ASSEMBLY INSTRUCTIONS

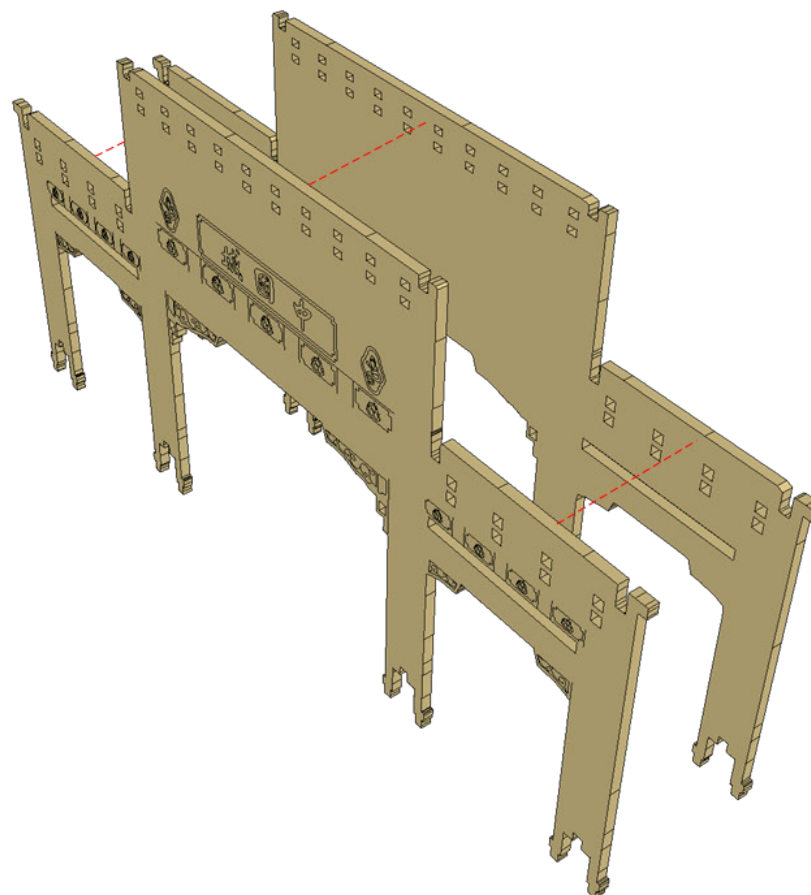

CHINATOWN GATE ASSEMBLY INSTRUCTIONS

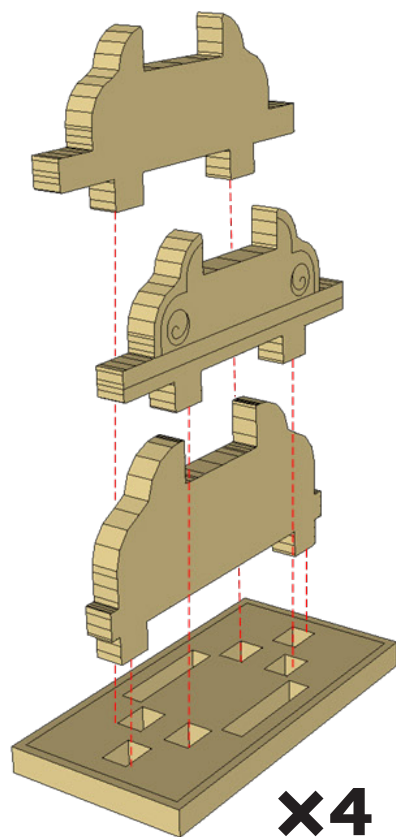
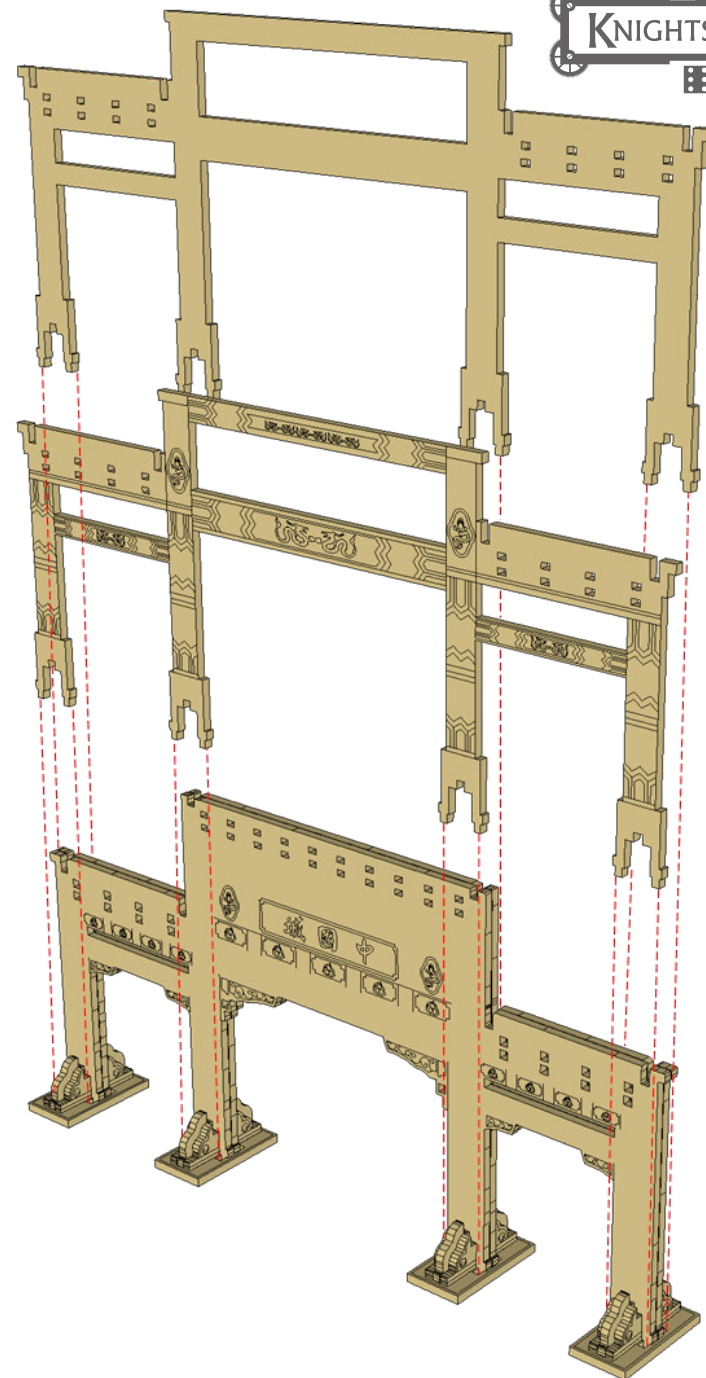
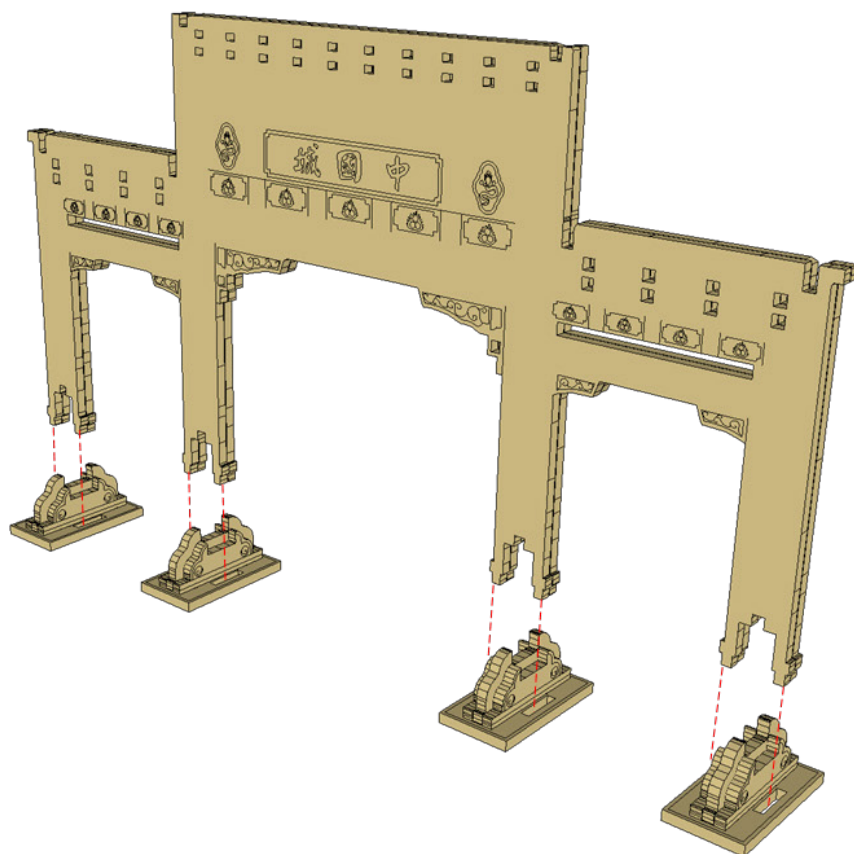

CHINATOWN GATE ASSEMBLY INSTRUCTIONS

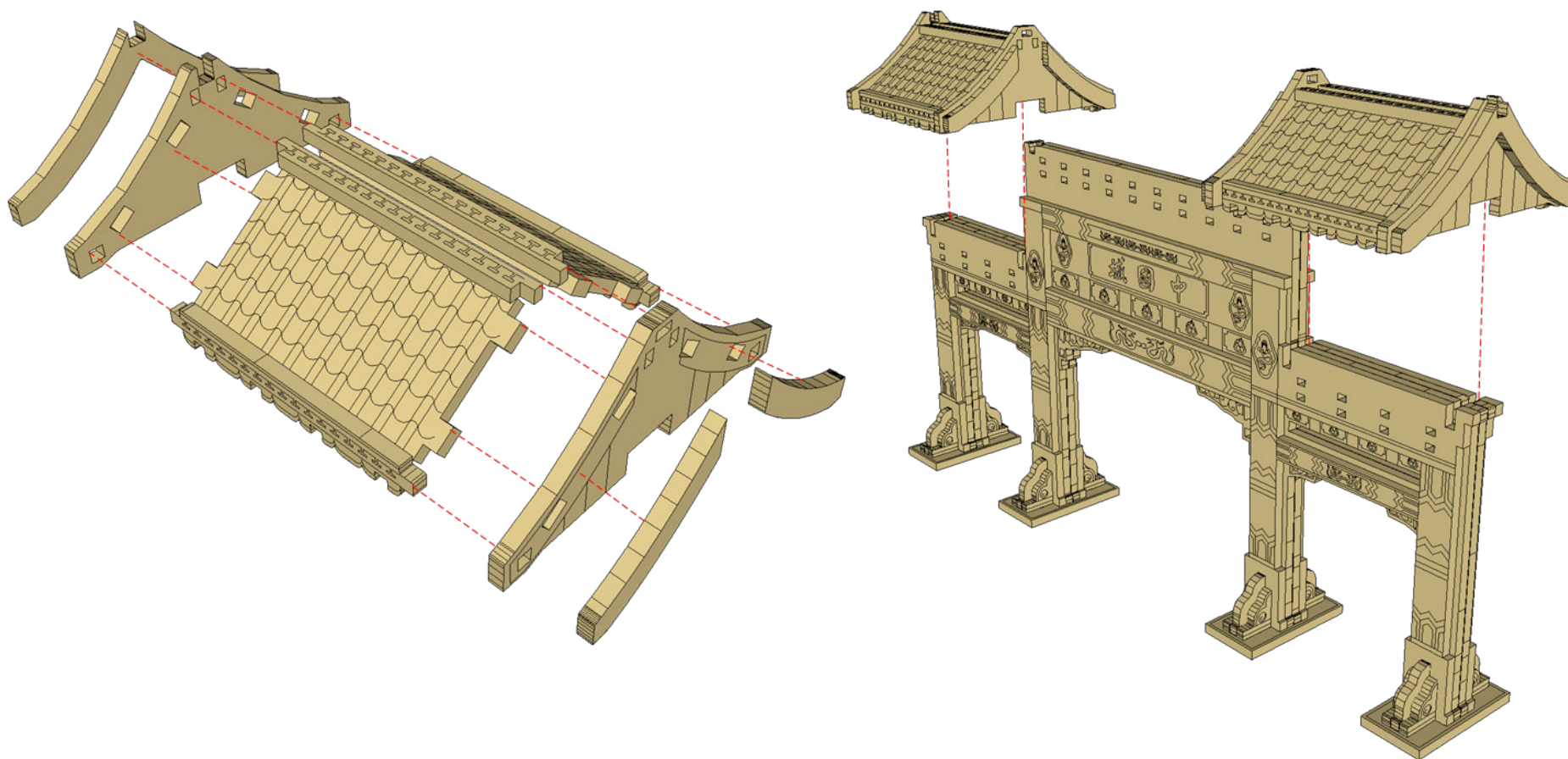

CHINATOWN GATE ASSEMBLY INSTRUCTIONS

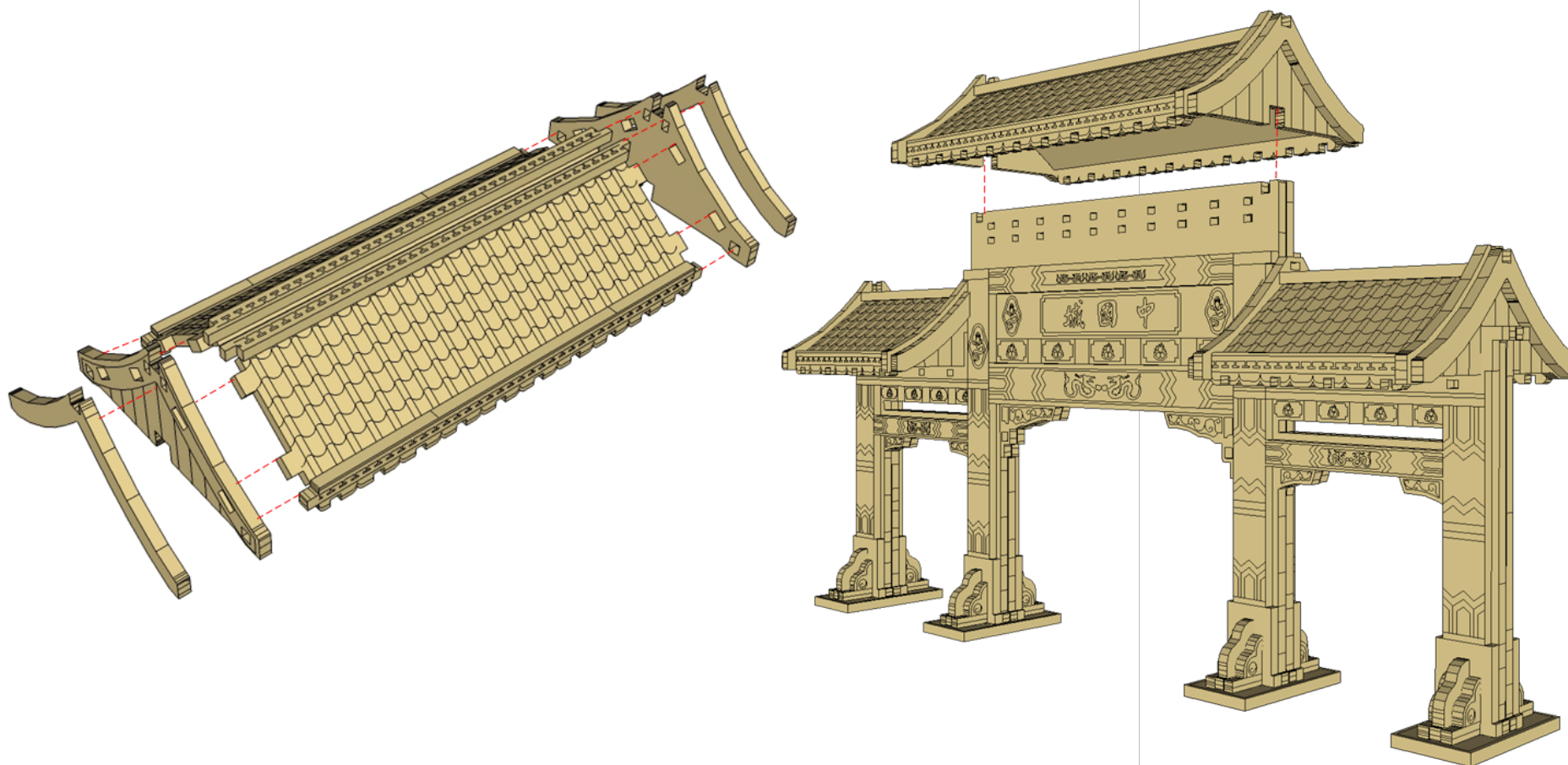

CHINATOWN GATE ASSEMBLY INSTRUCTIONS

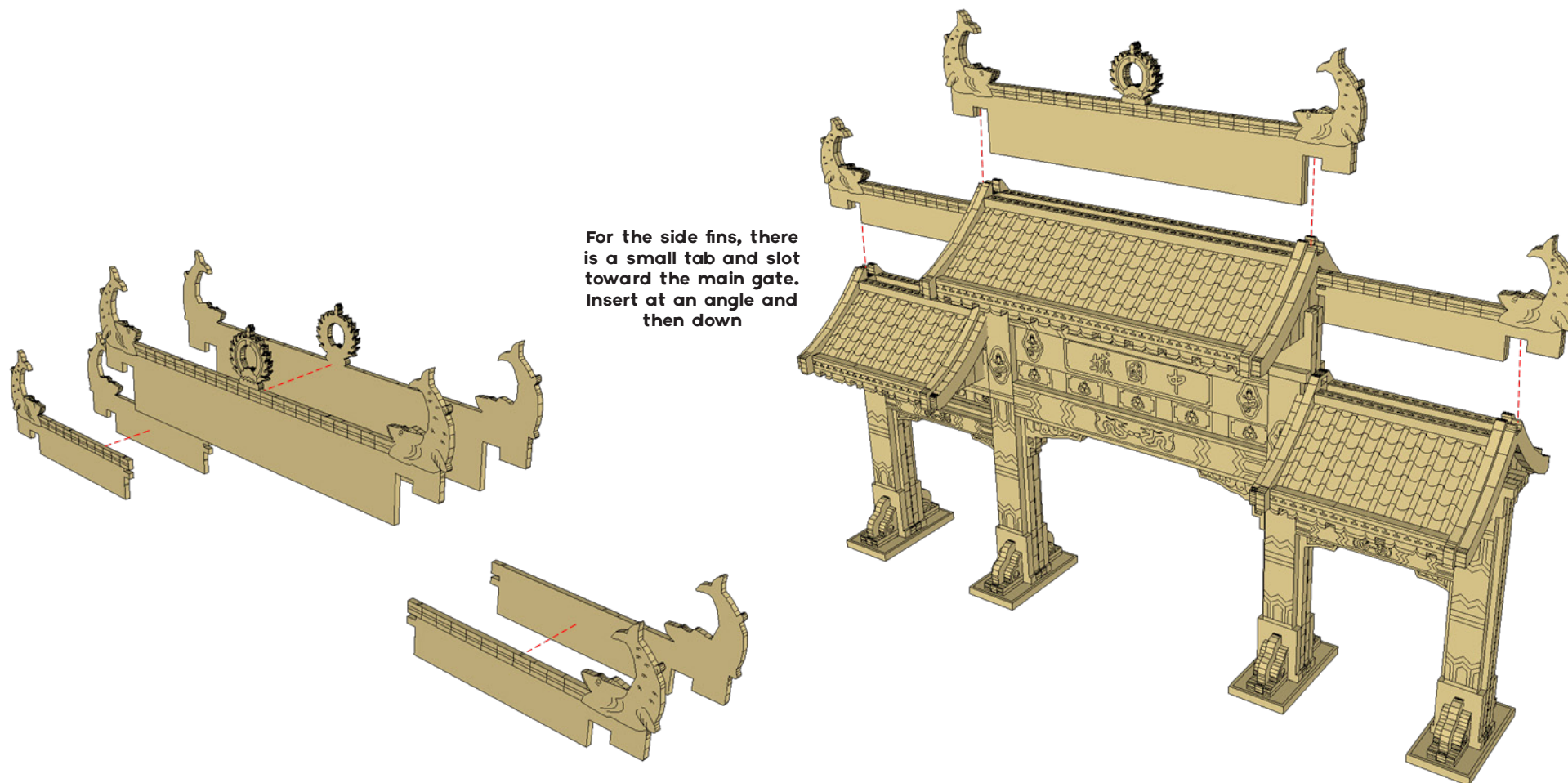

CHINATOWN GATE ASSEMBLY INSTRUCTIONS

The struts have a slight upward sweep to them. To achieve this, insert the pegs into the main body of the gate, then push up to get them into the proper position

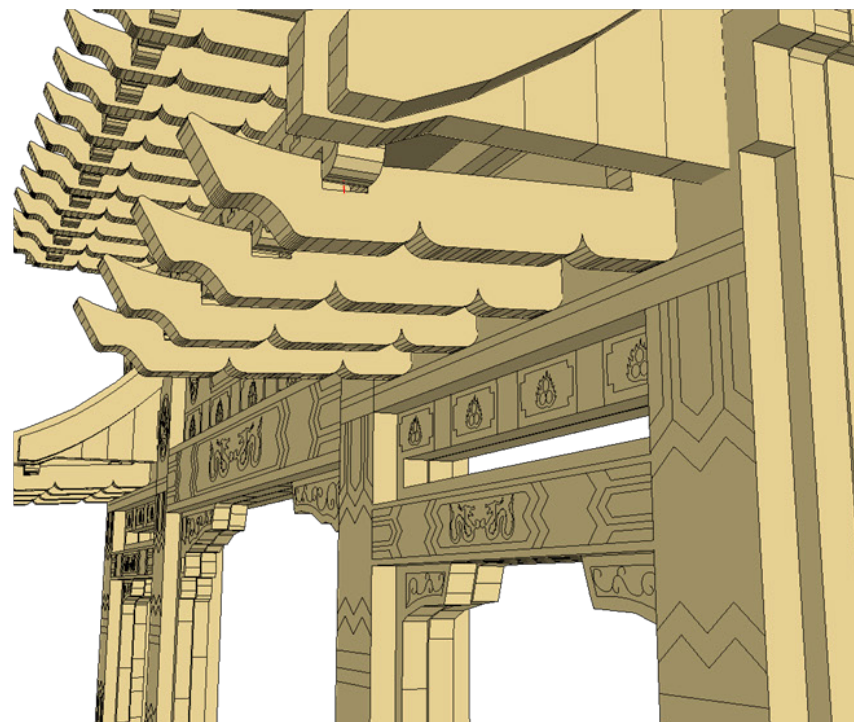
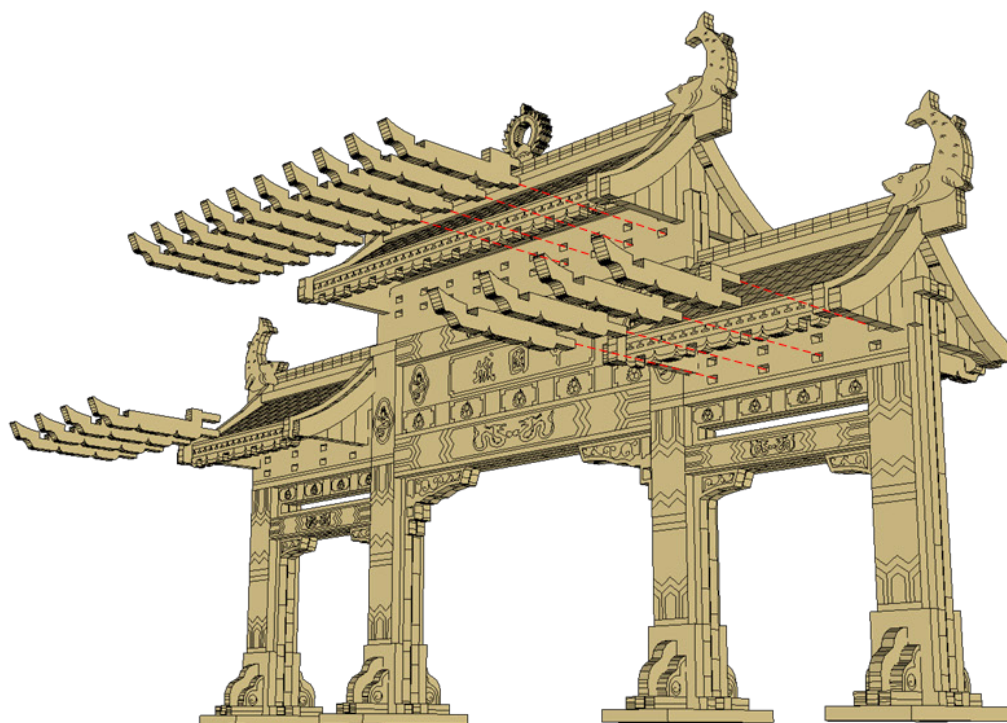

CHINATOWN GATE ASSEMBLY INSTRUCTIONS

