

DAINTY SICHAUN ASSEMBLY INSTRUCTIONS

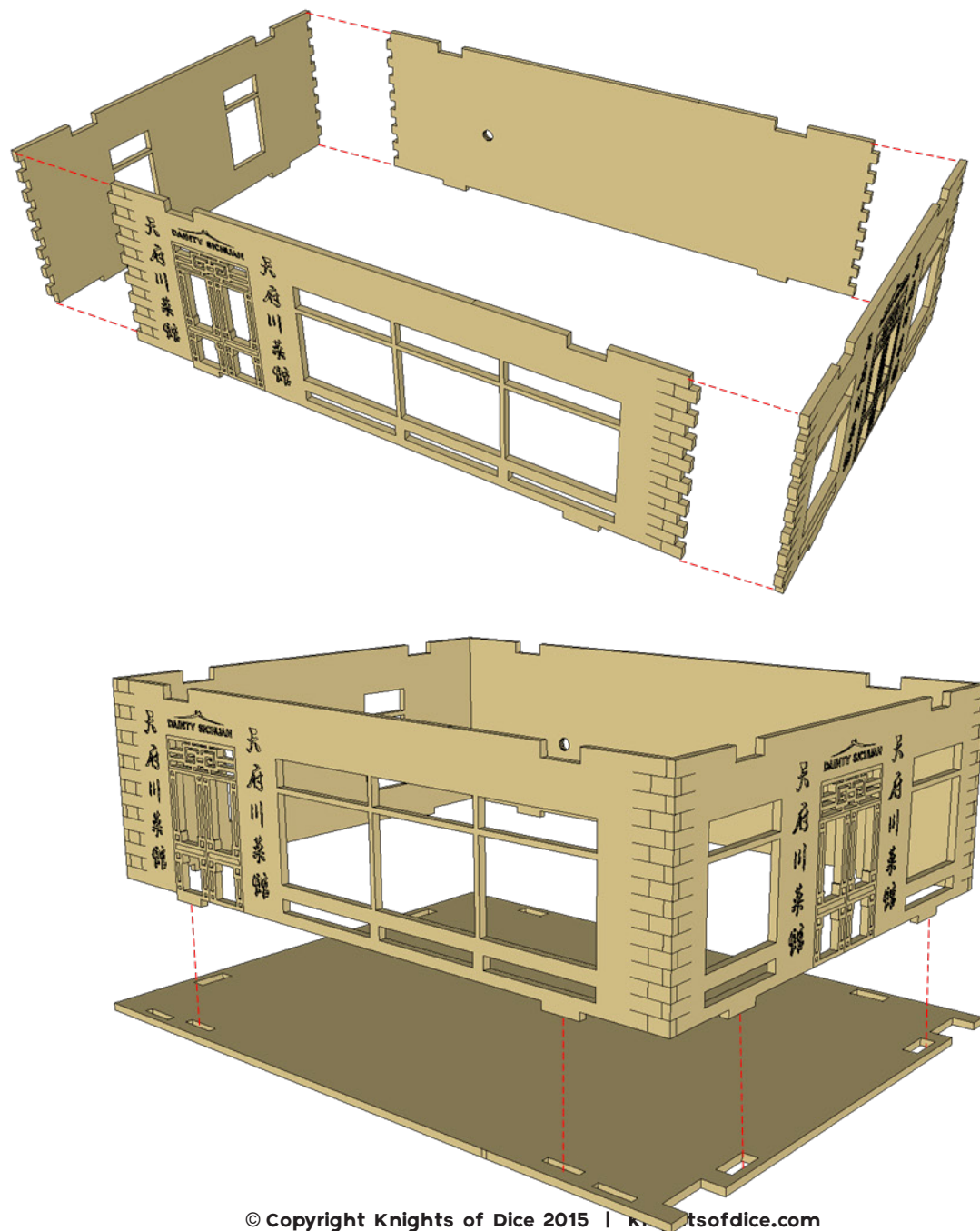

DAINTY SICHAUN ASSEMBLY INSTRUCTIONS

We've found it useful to
Apply glue to the facade pieces, then slot
them into the holes on the base piece.
Make sure you have the correct facade
piece for the correct side (as some side
have doors and corresponding facades).
Small clamps or large elastic bands also
help with securing the facade pieces
while they dry

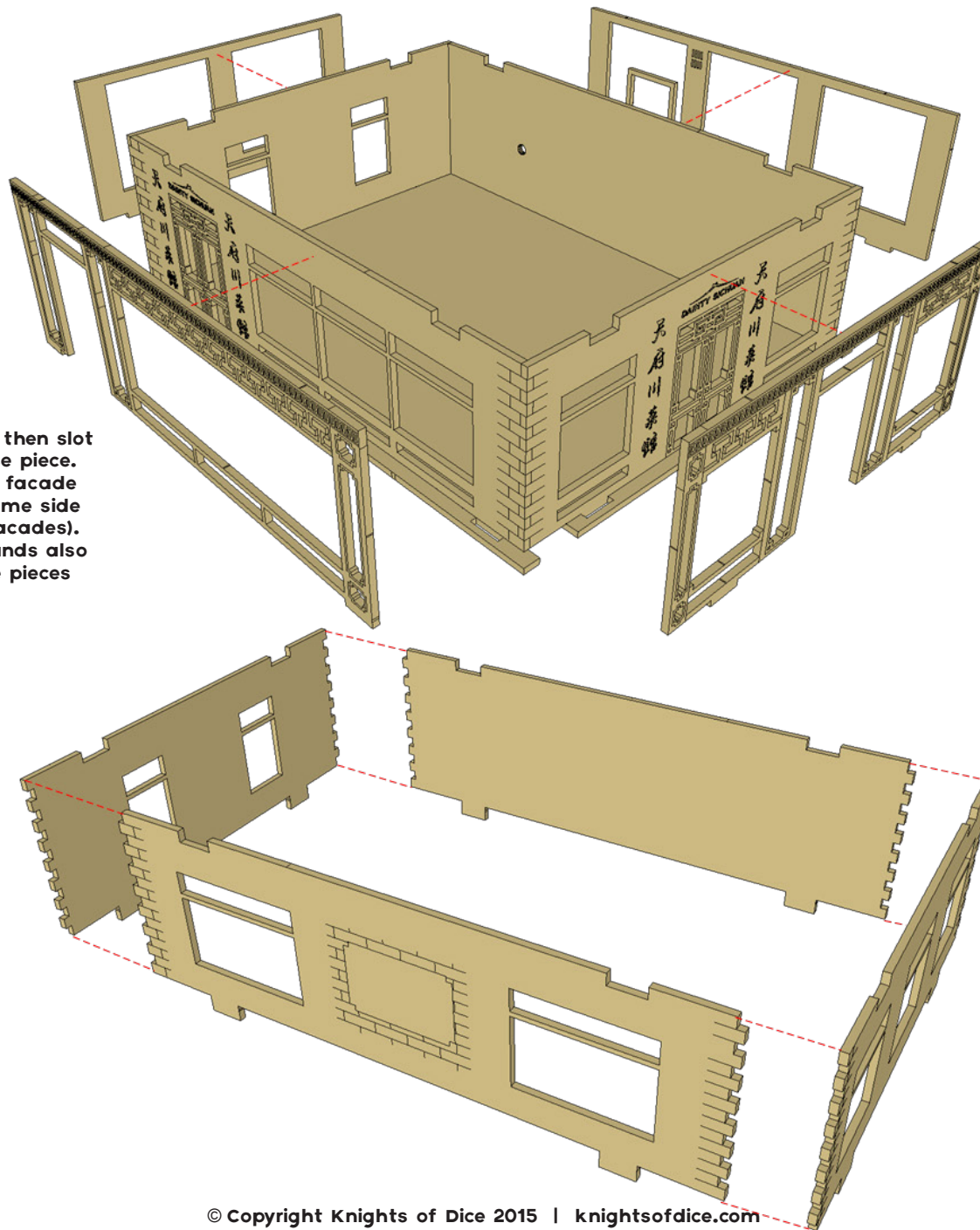

DAINTY SICHAUN ASSEMBLY INSTRUCTIONS

The pegs extend through the base piece to form lugs for locking into the first floor

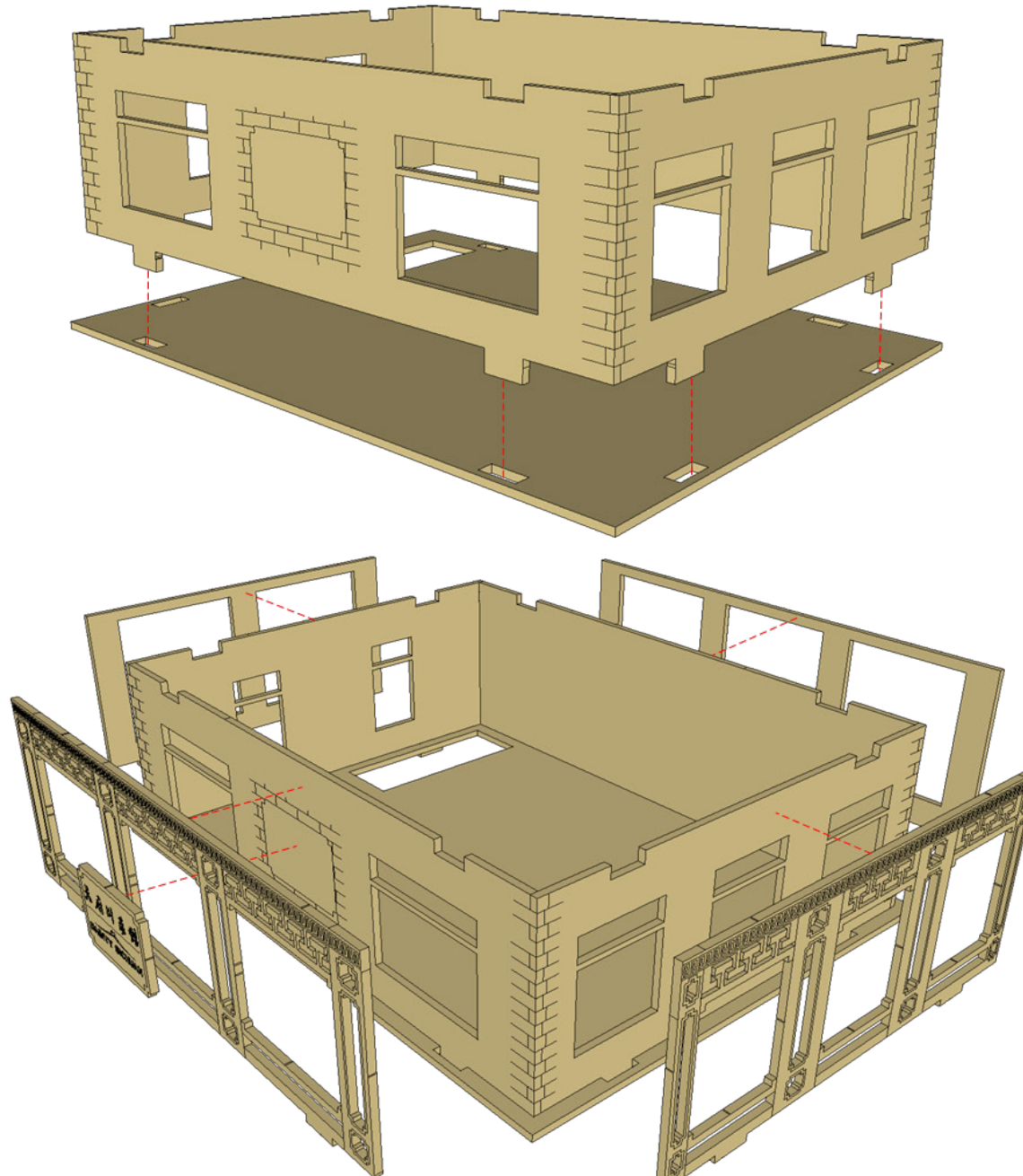

DAINTY SICHAUN ASSEMBLY INSTRUCTIONS

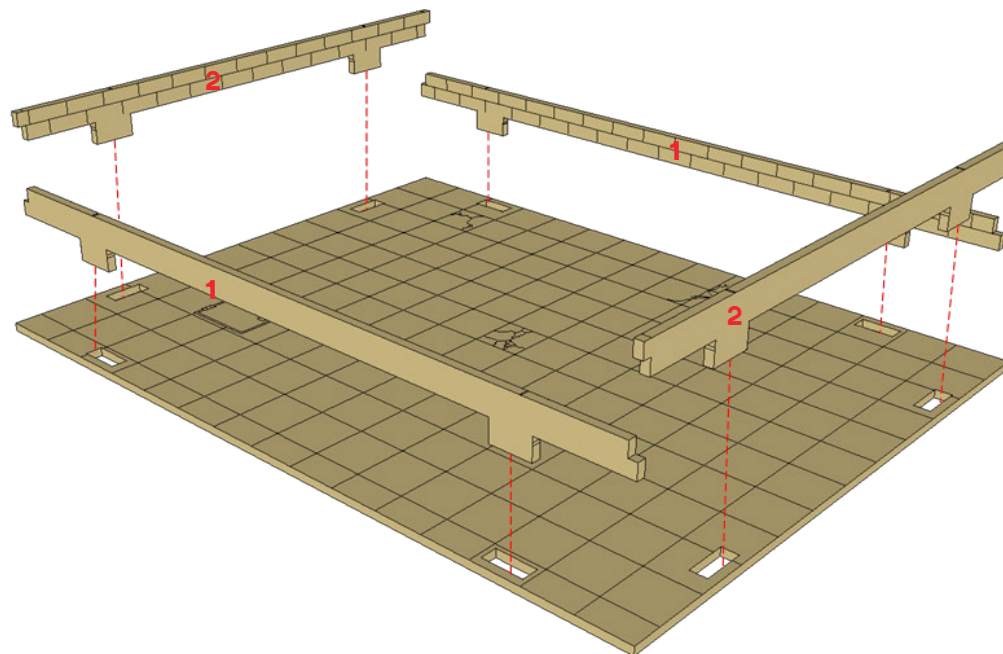

Glue the roof trim in the numbered order. The pegs extend through the roof piece to form lugs for locking into the second floor

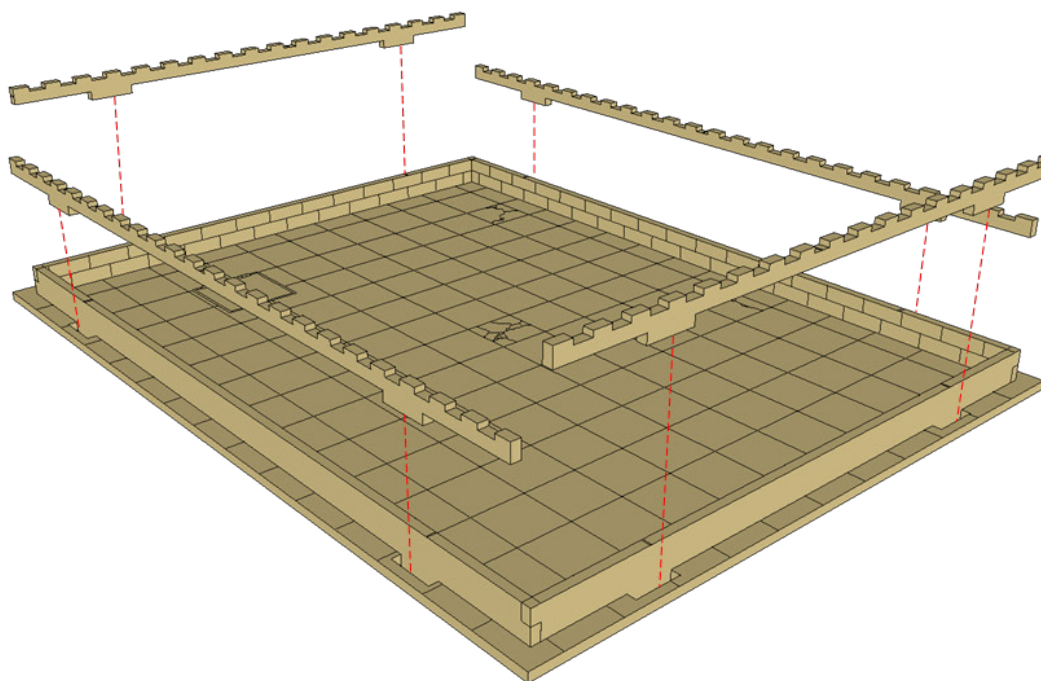

DAINTY SICHAUN ASSEMBLY INSTRUCTIONS

Don't glue your levels in place, you want to be able to access the interior. The outside courtyard is designed to be removable for ease of storage. It simply slots into the bottom of the first floor

