

ELARIAN STOREHOUSE INSTRUCTIONS

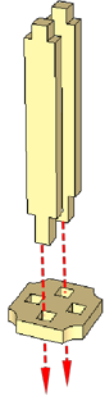

Keep a look out for the longer tabs. They should be parallel to each other

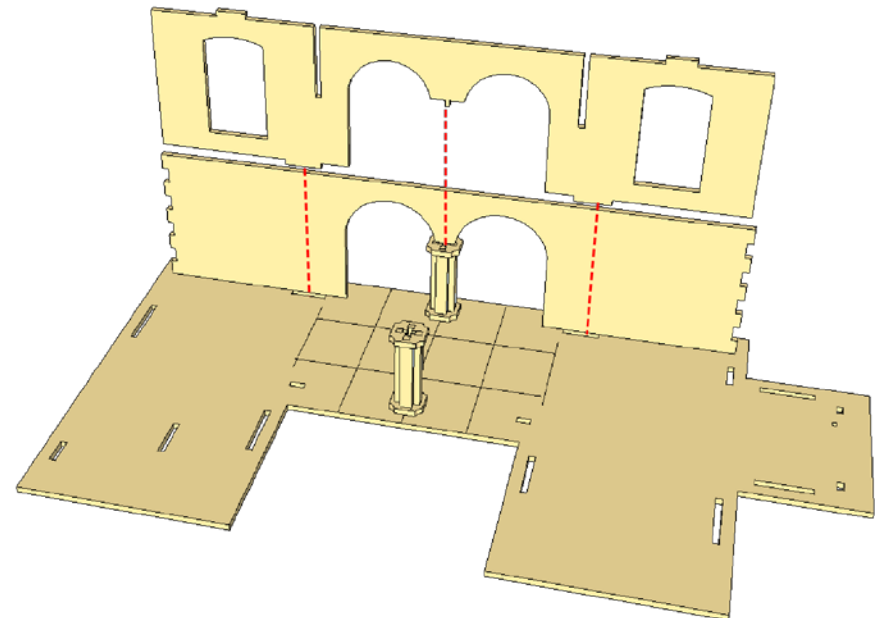
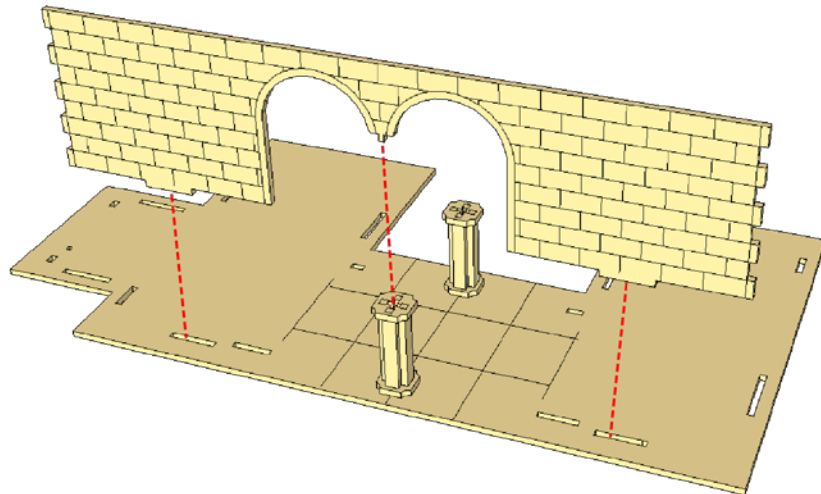
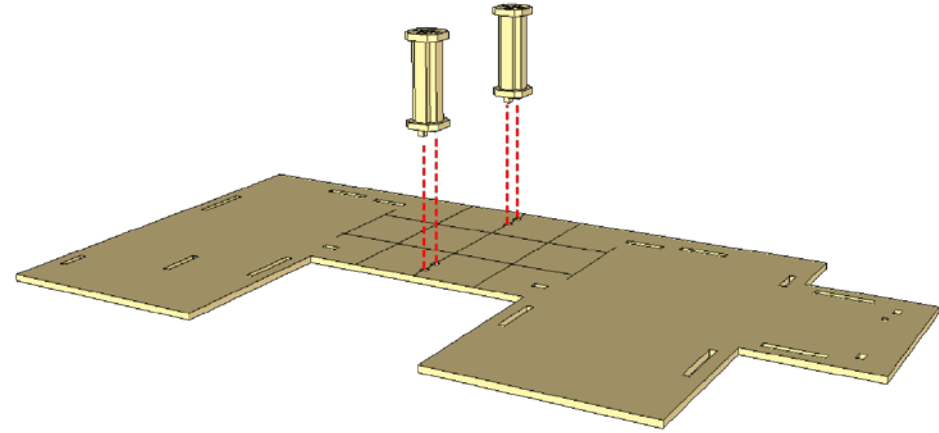
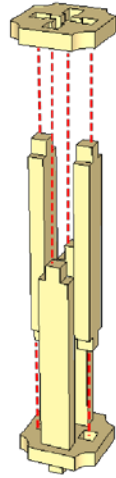

ELARIAN STOREHOUSE INSTRUCTIONS

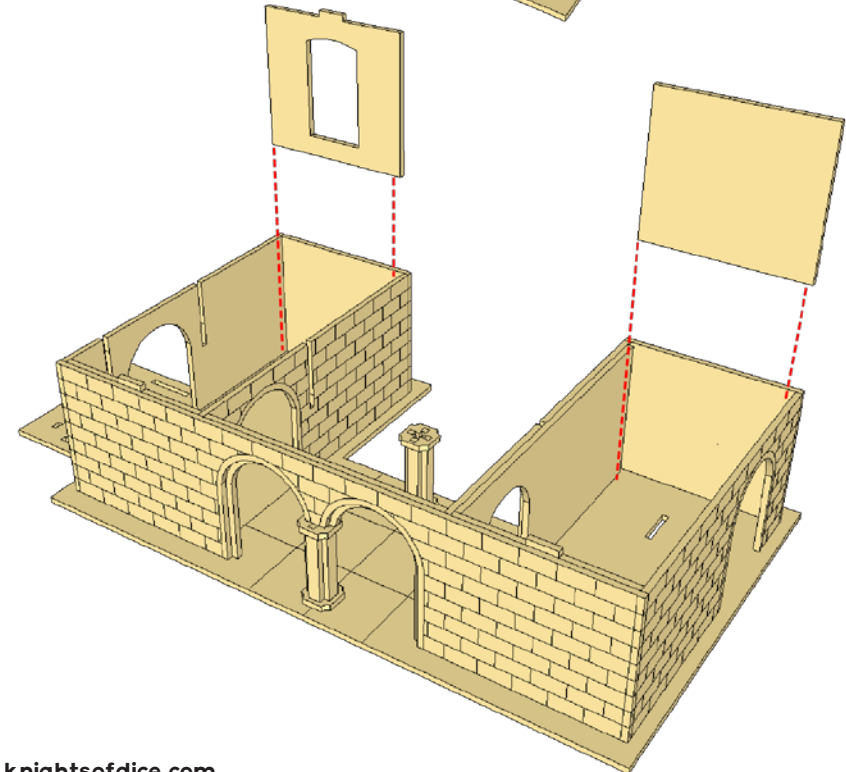
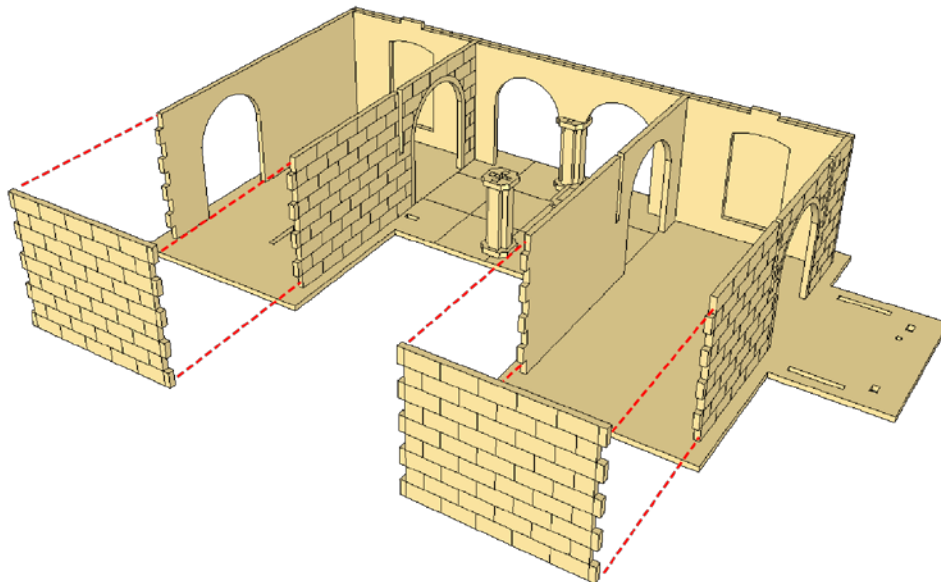
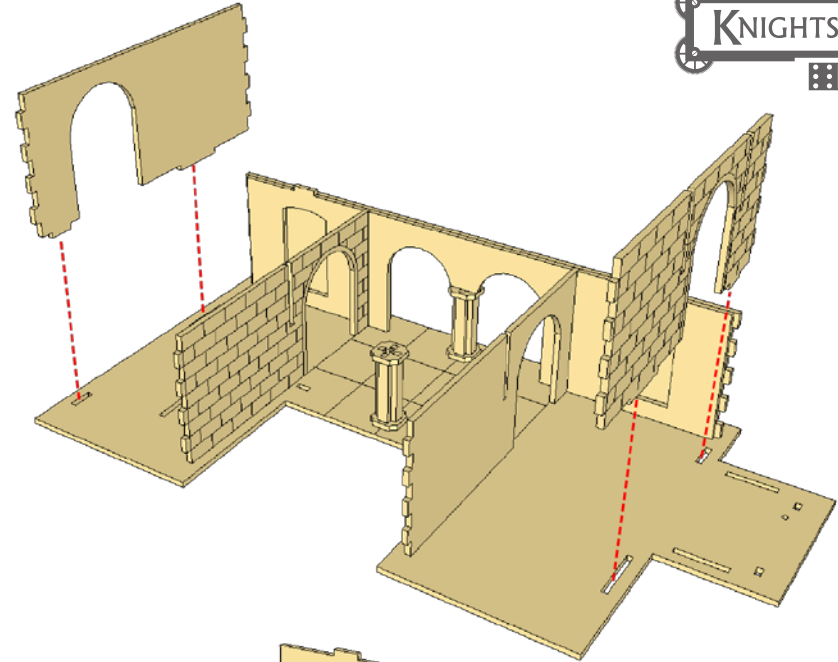
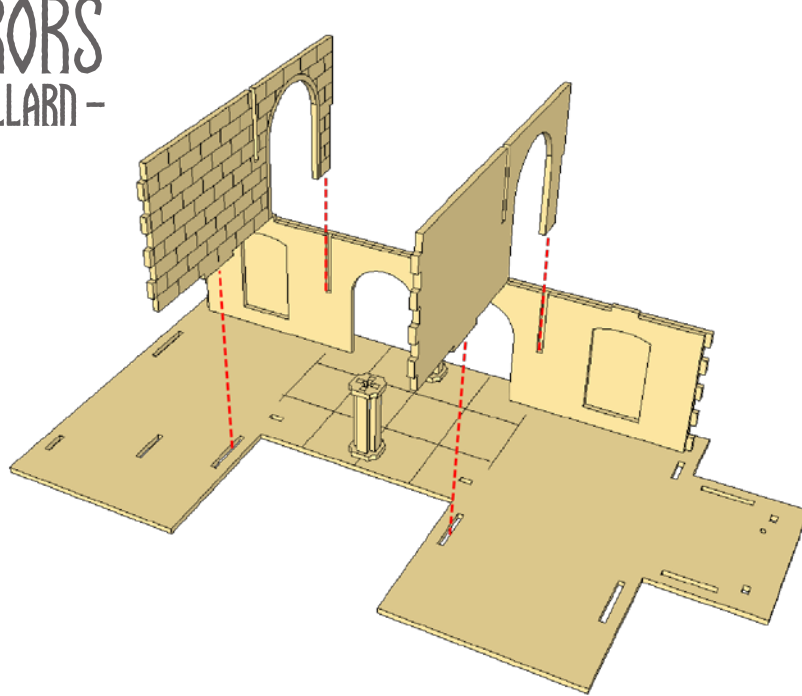

ELARIAN STOREHOUSE INSTRUCTIONS

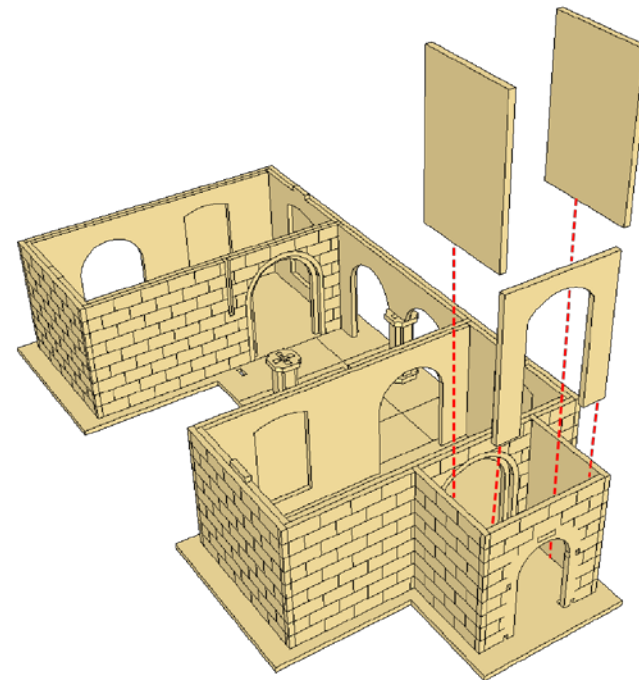
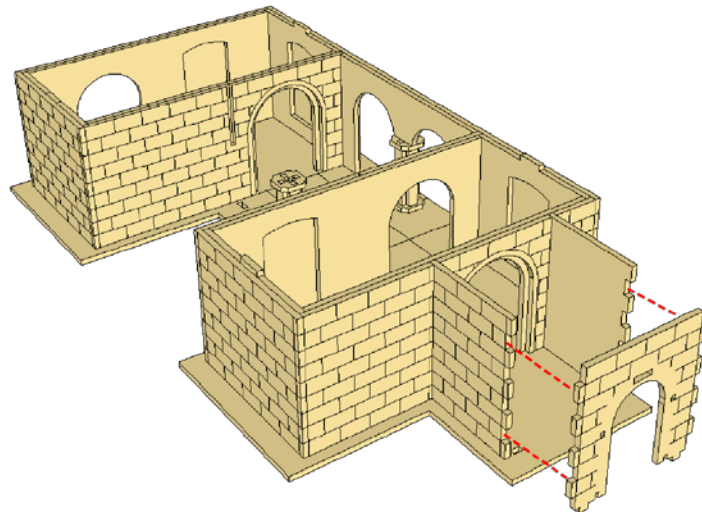
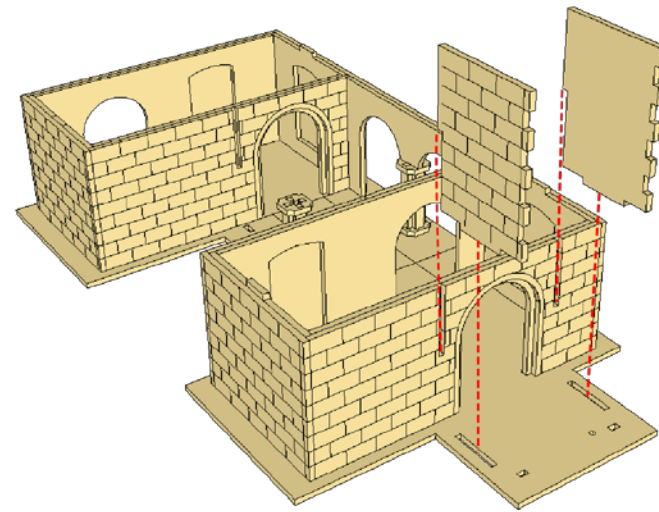
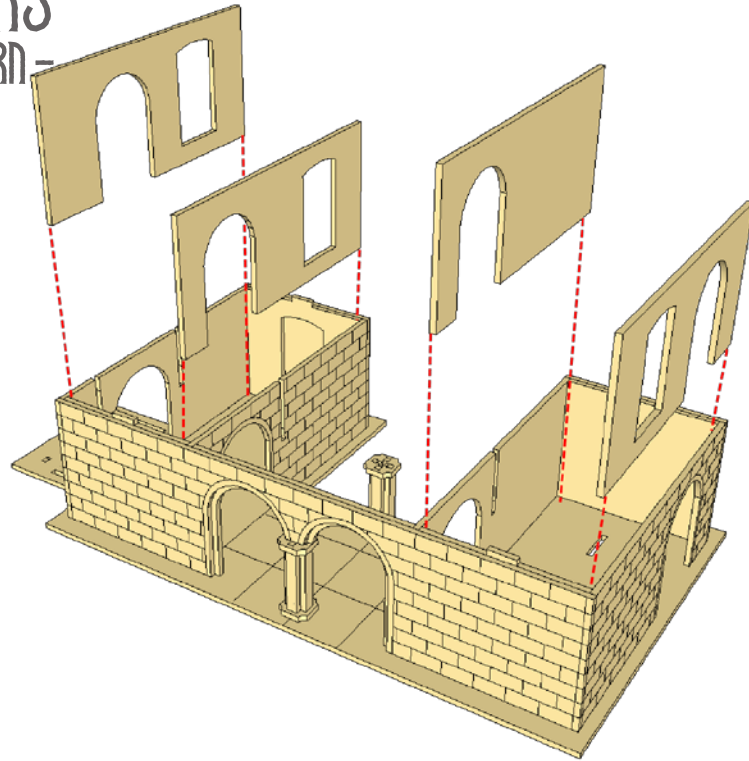

ELARIAN STOREHOUSE INSTRUCTIONS

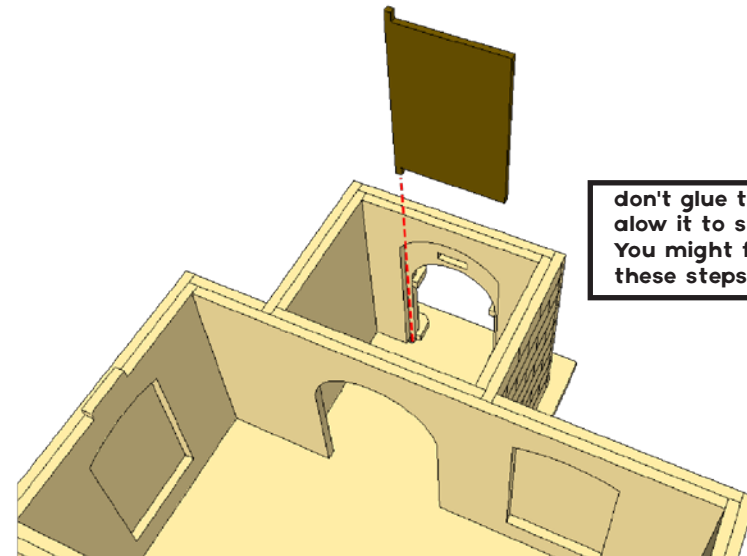
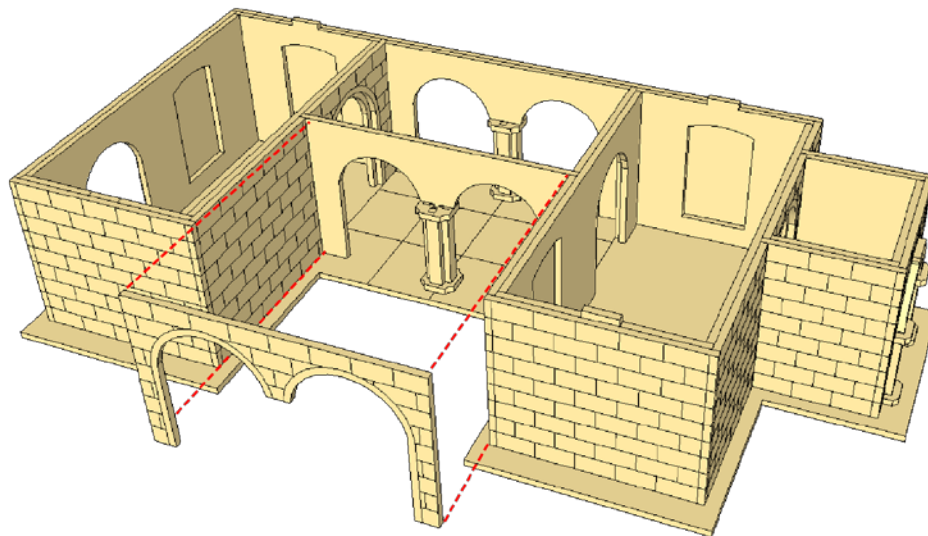
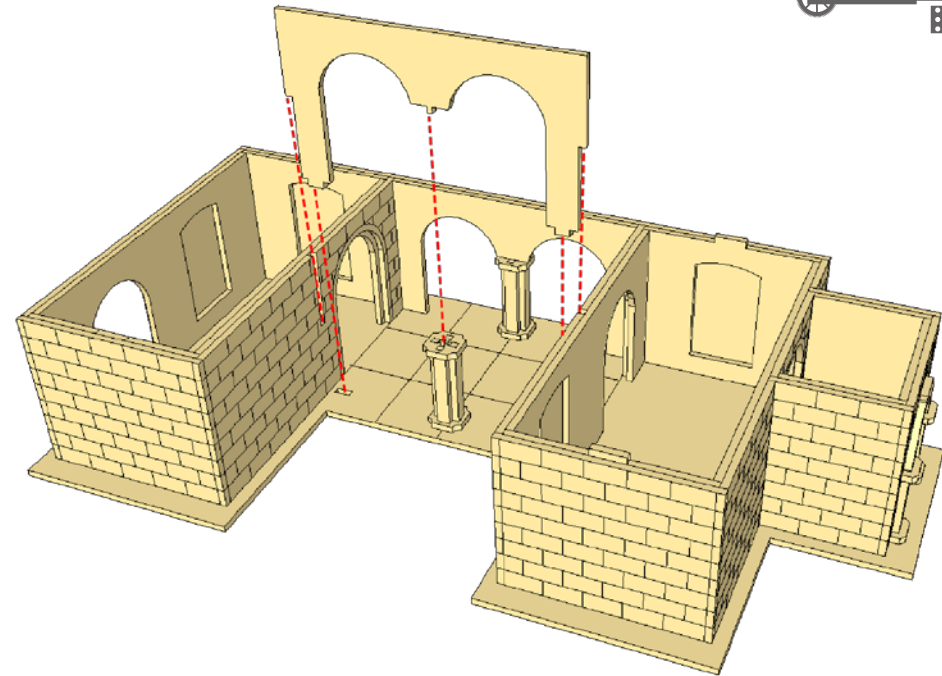
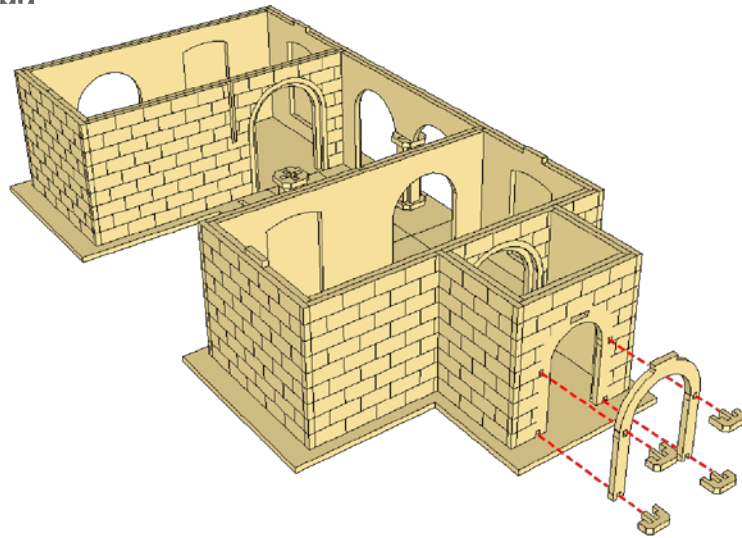

don't glue the door in! this will allow it to sing open and closed. You might find it easier to do these steps after painting



ELARIAN STOREHOUSE INSTRUCTIONS

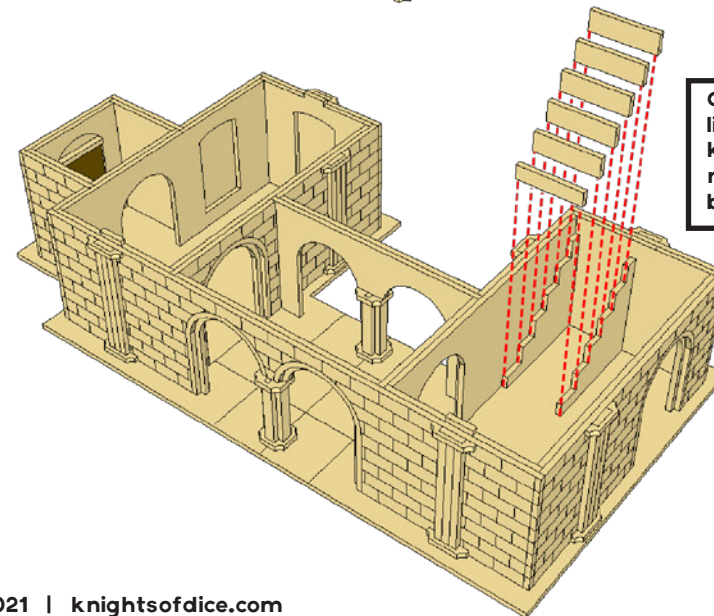
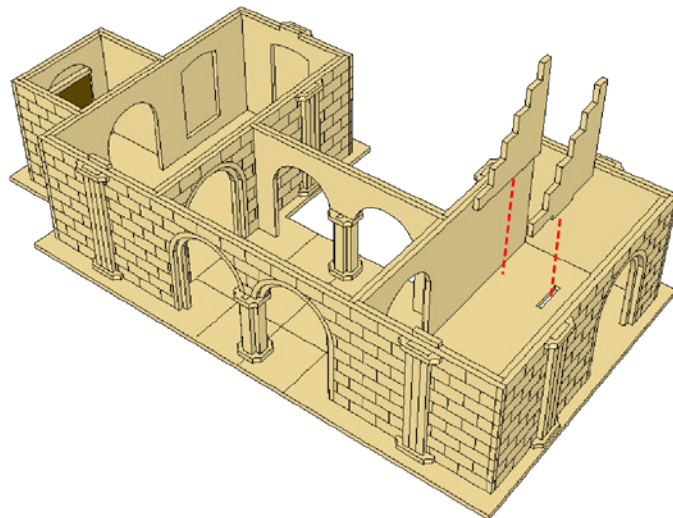
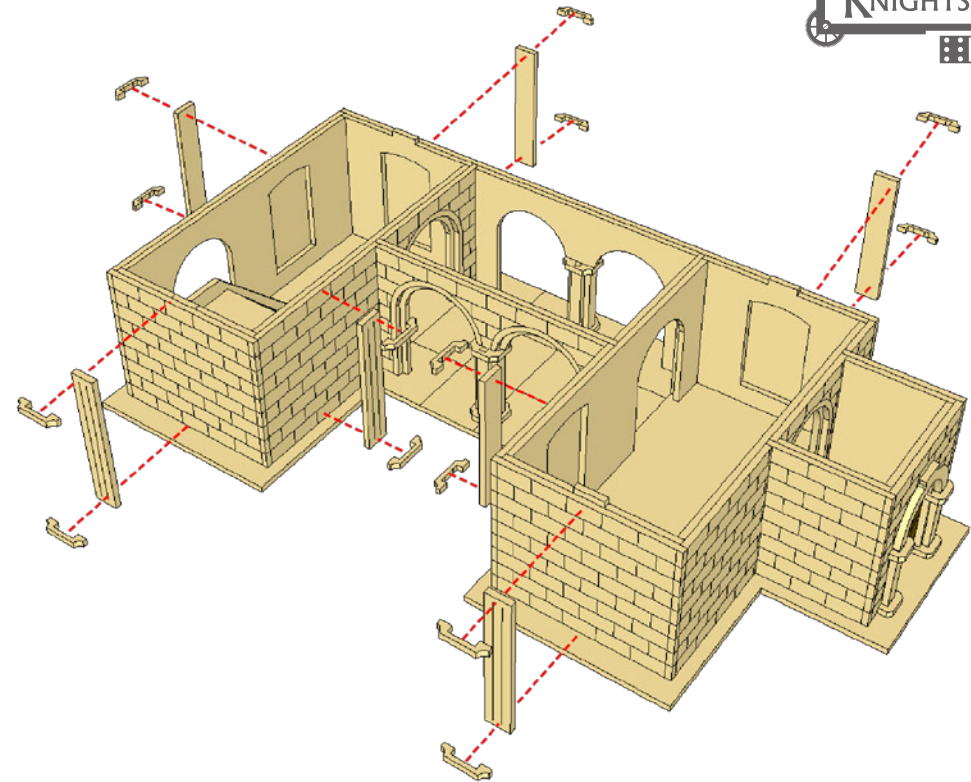
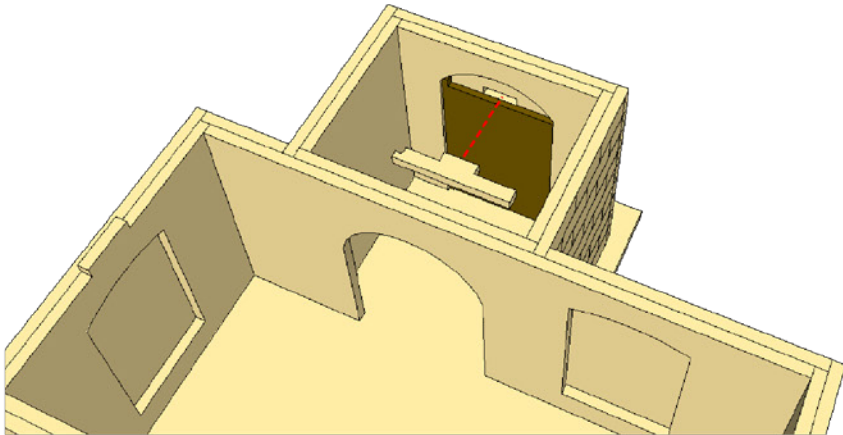

One of these things is not like the others! One of the kickplates is smaller than the rest, this plate goes on the bottom (first step!)

ELARIAN STOREHOUSE INSTRUCTIONS

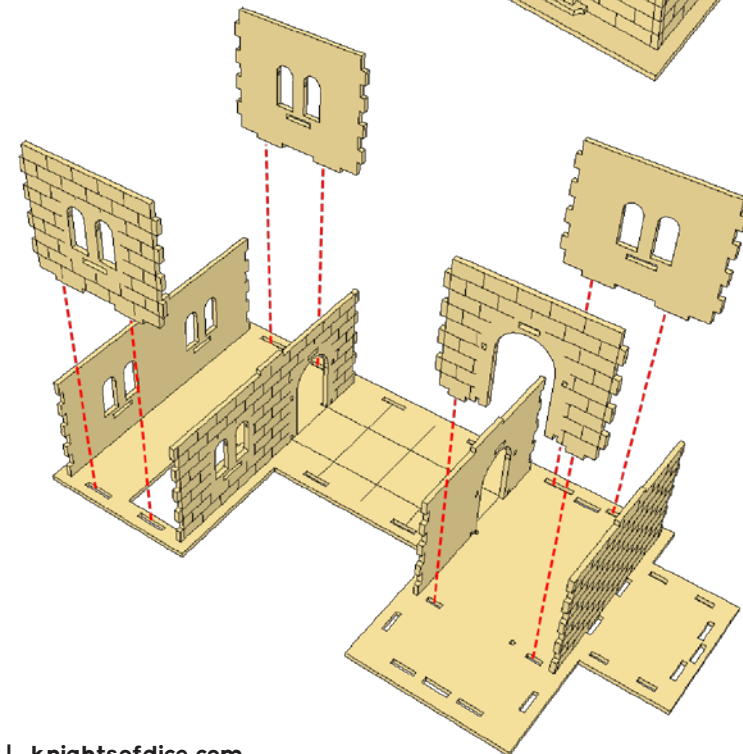
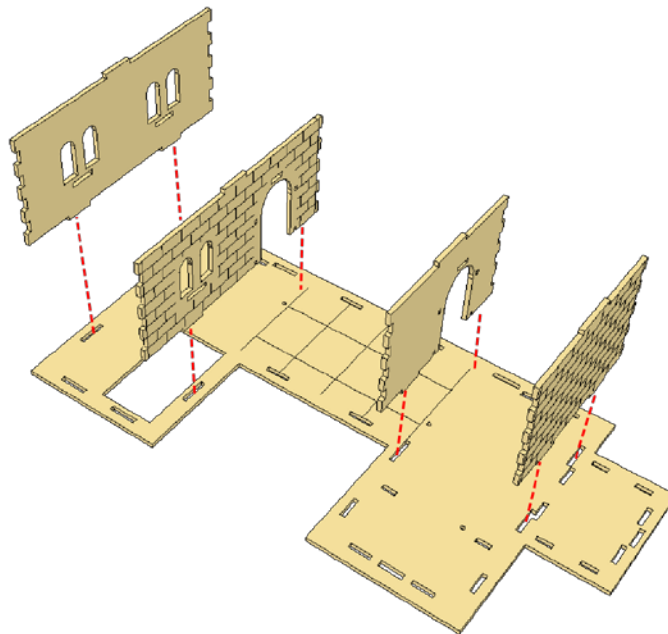
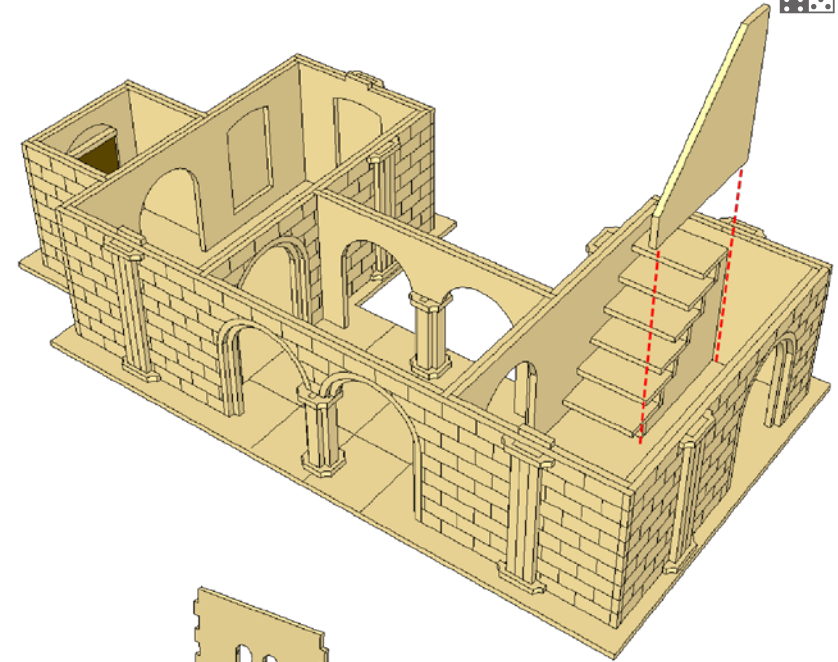
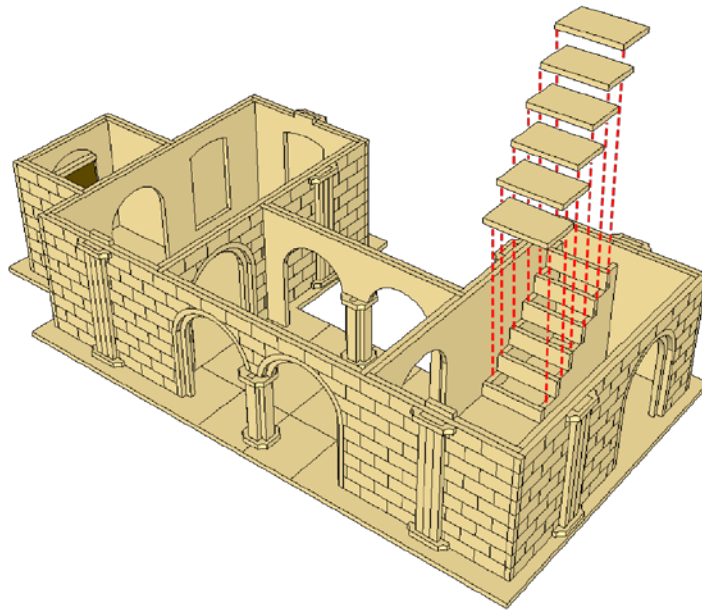

ELARIAN STOREHOUSE INSTRUCTIONS

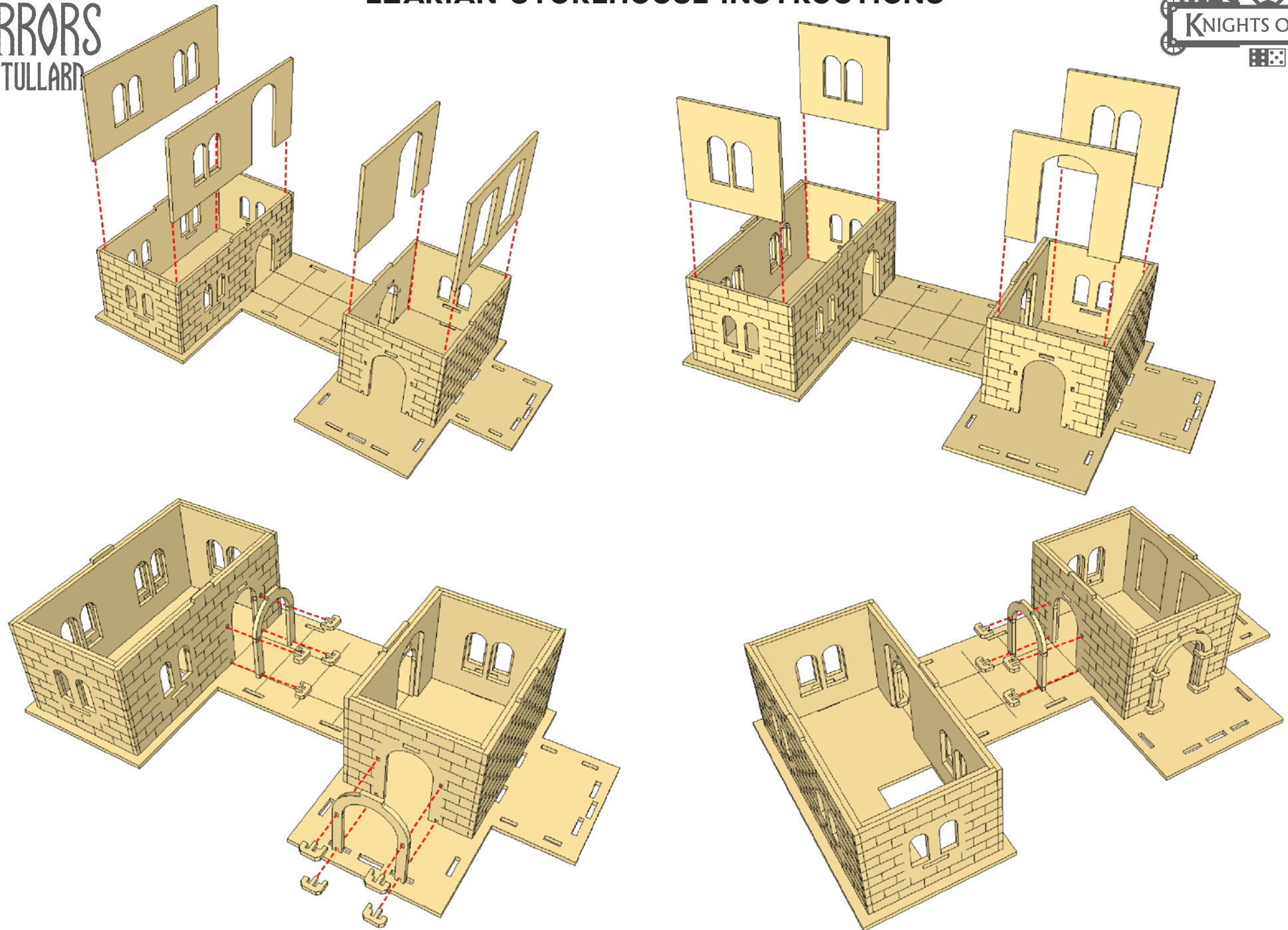

ELARIAN STOREHOUSE INSTRUCTIONS

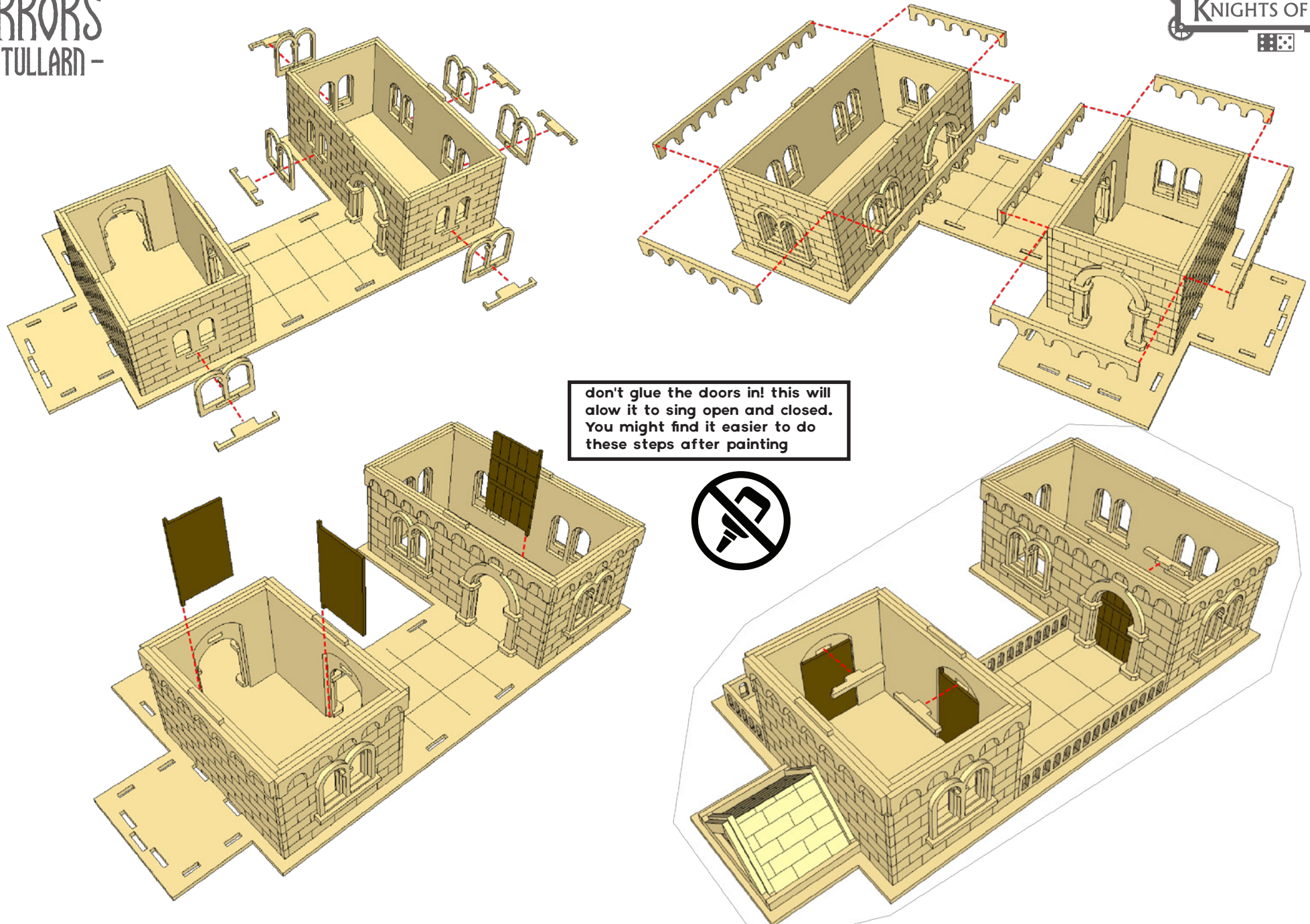

ELARIAN STOREHOUSE INSTRUCTIONS

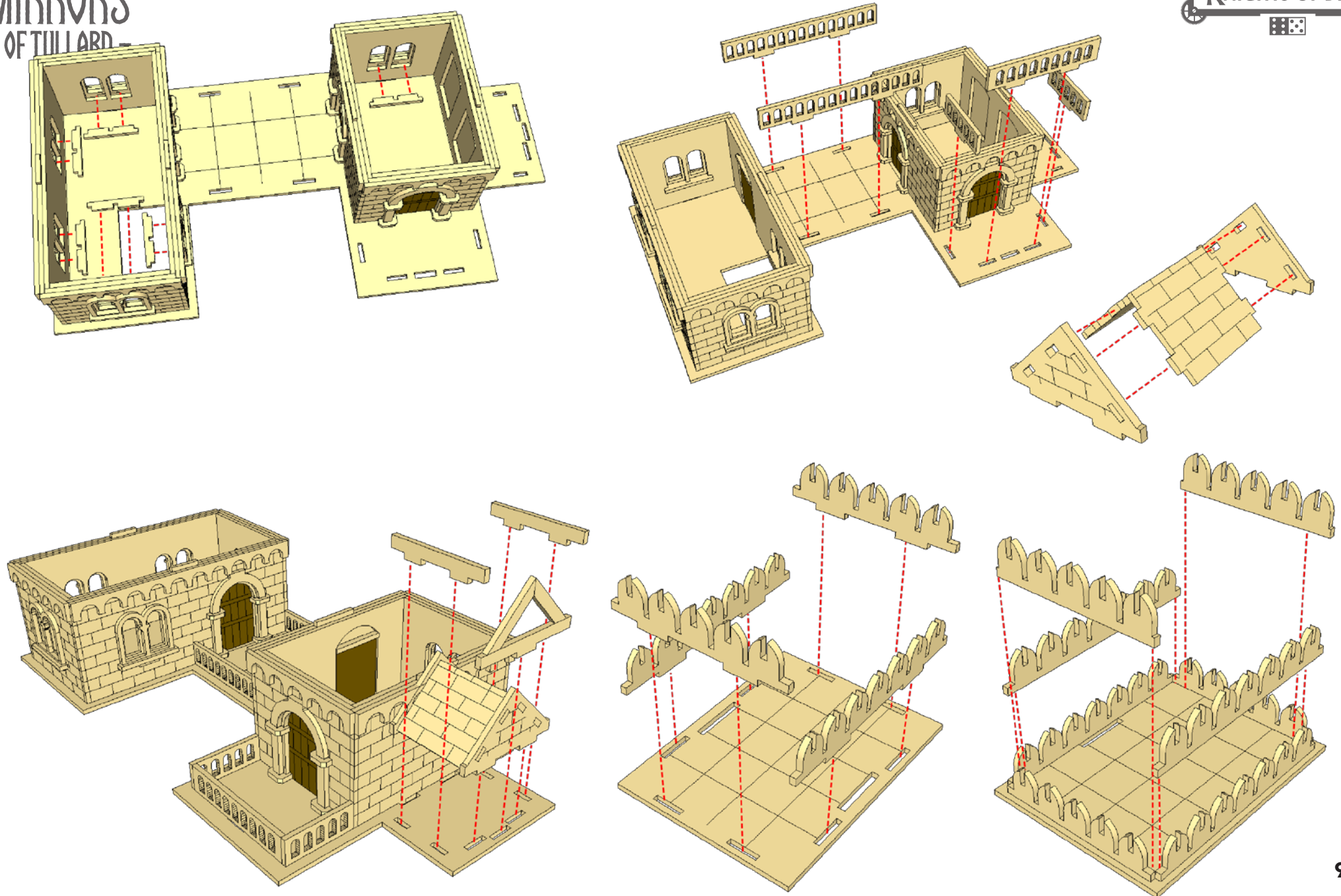

ELARIAN STOREHOUSE INSTRUCTIONS

