

# LITTLE RAMEN ASSEMBLY INSTRUCTIONS

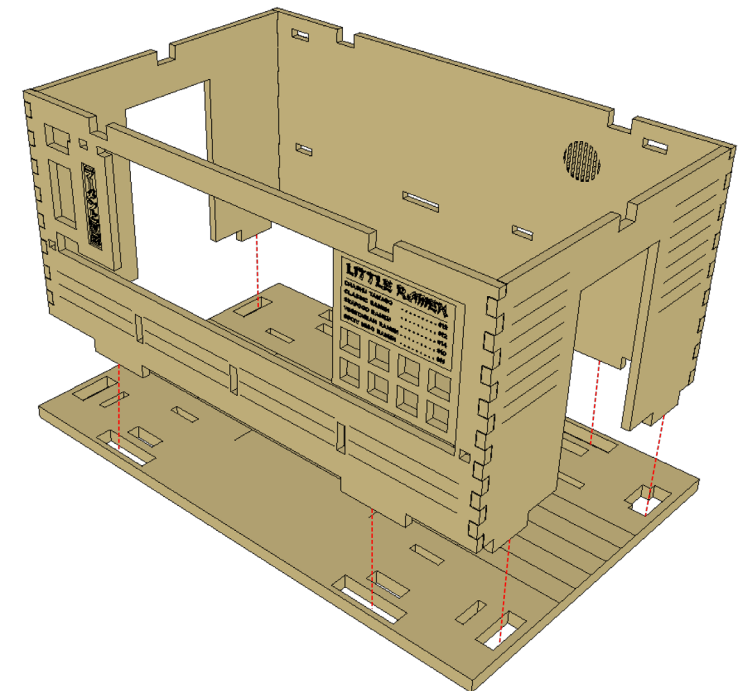

# LITTLE RAMEN ASSEMBLY INSTRUCTIONS

We've found it useful to  
Apply glue to the facade pieces, then slot  
them into the holes on the base piece.  
Make sure you have the correct facade  
piece for the correct side (as some side  
have doors and corresponding facades).  
Small clamps or large elastic bands also  
help with securing the facade pieces  
while they dry

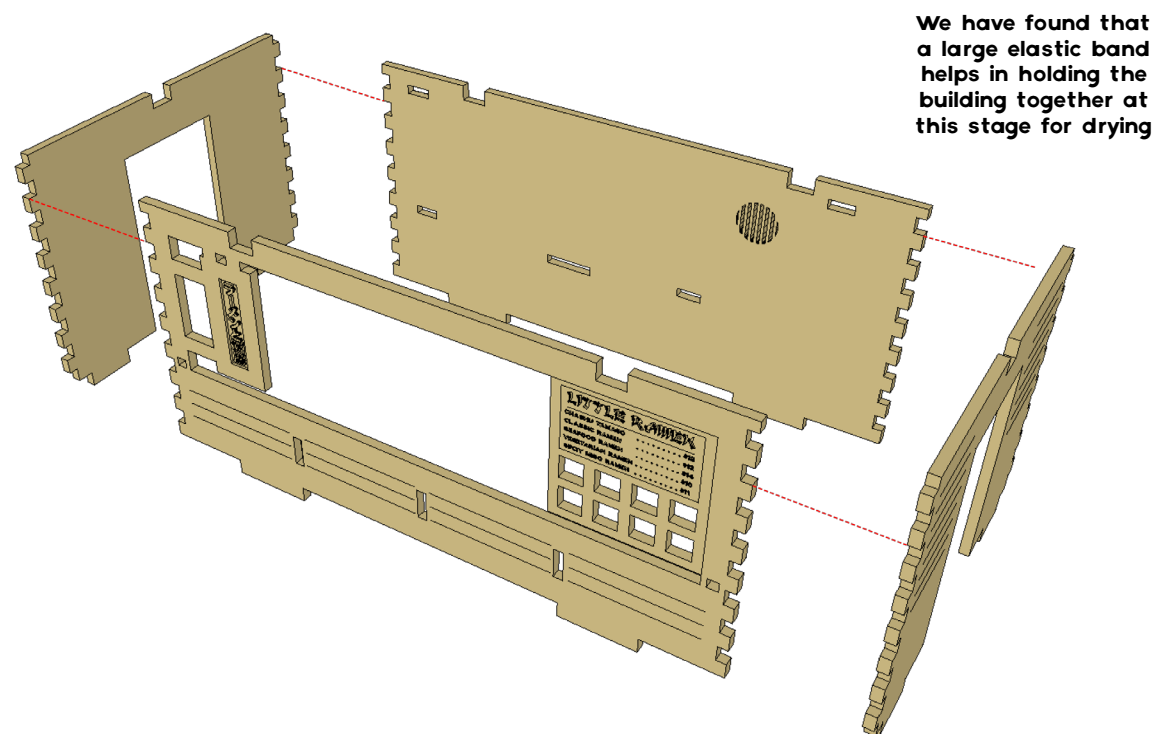
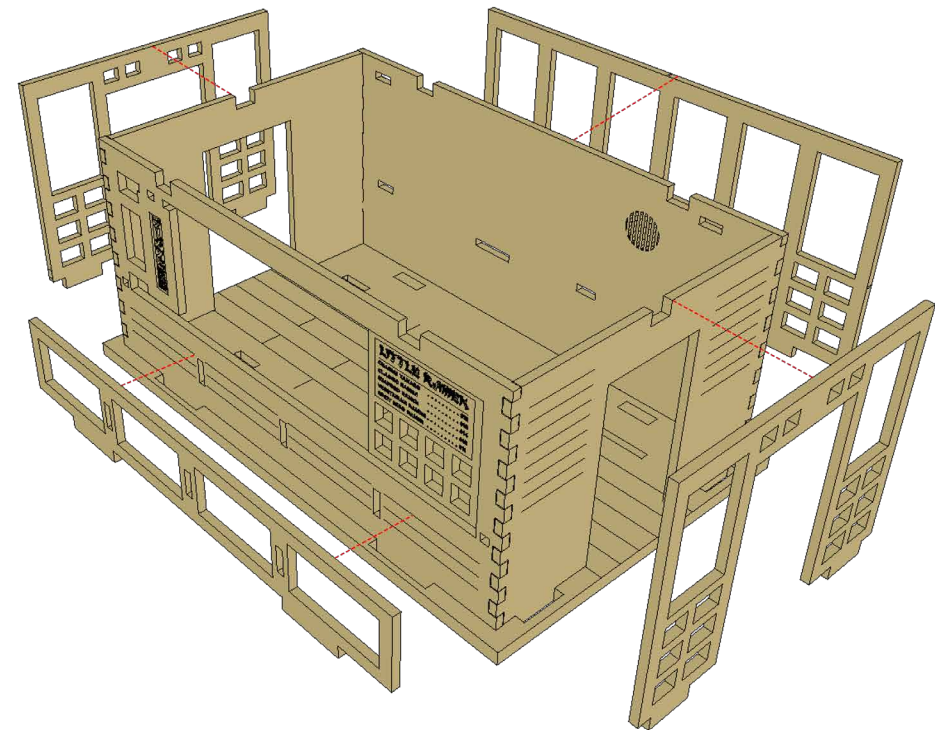
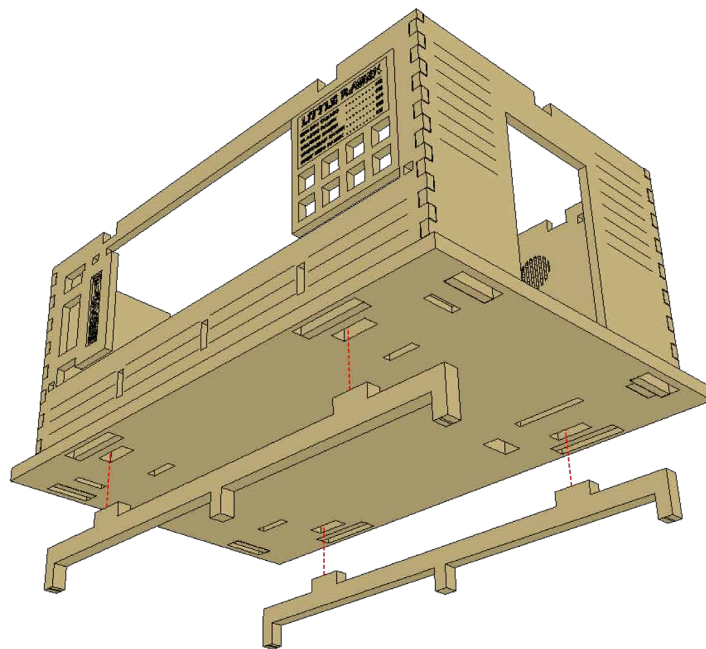

# LITTLE RAMEN ASSEMBLY INSTRUCTIONS

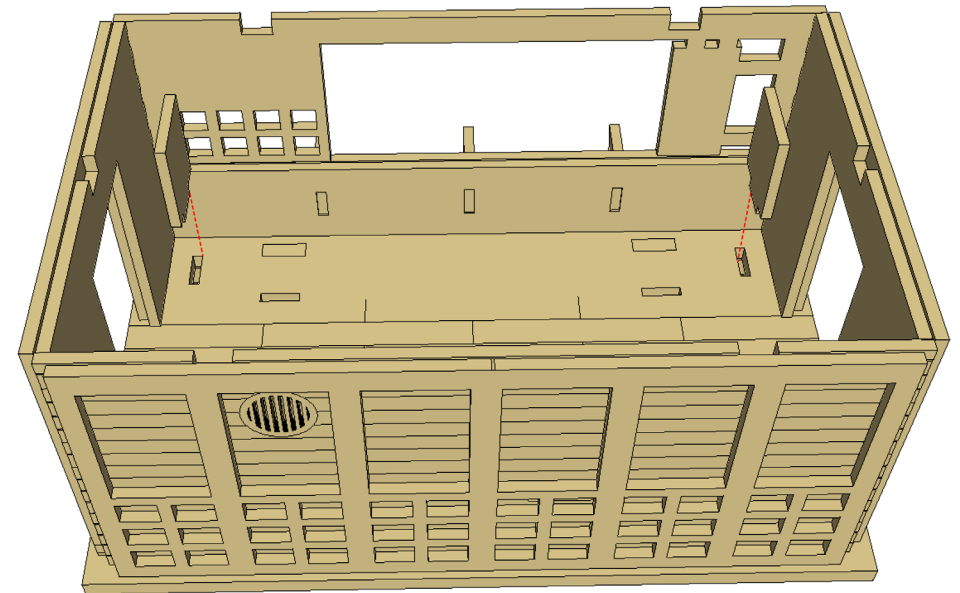
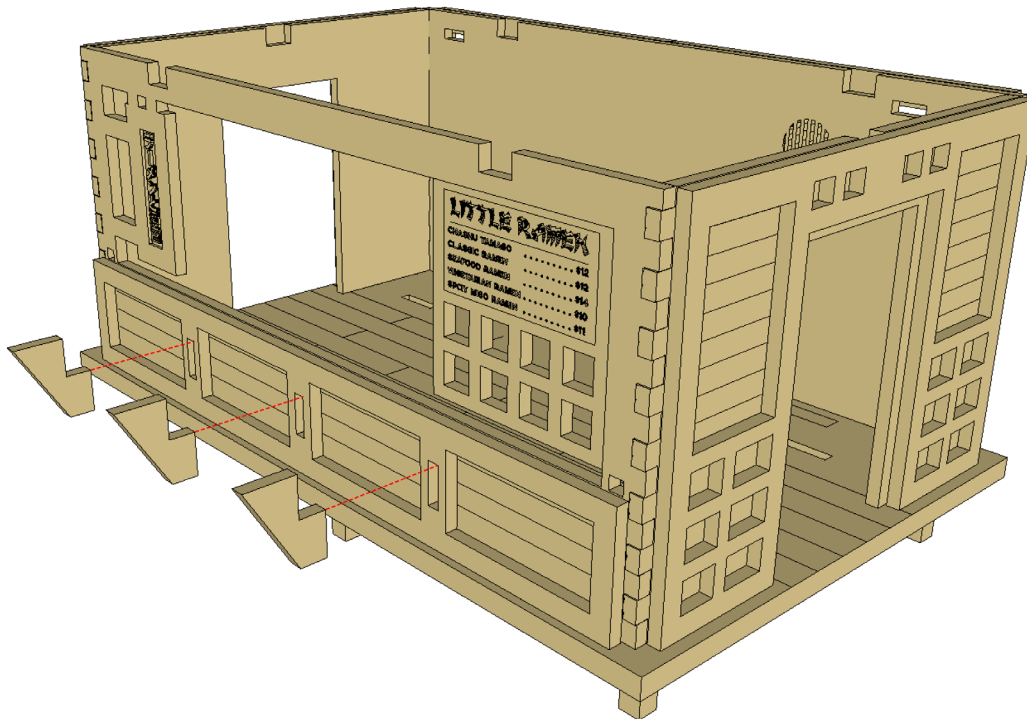

# LITTLE RAMEN ASSEMBLY INSTRUCTIONS

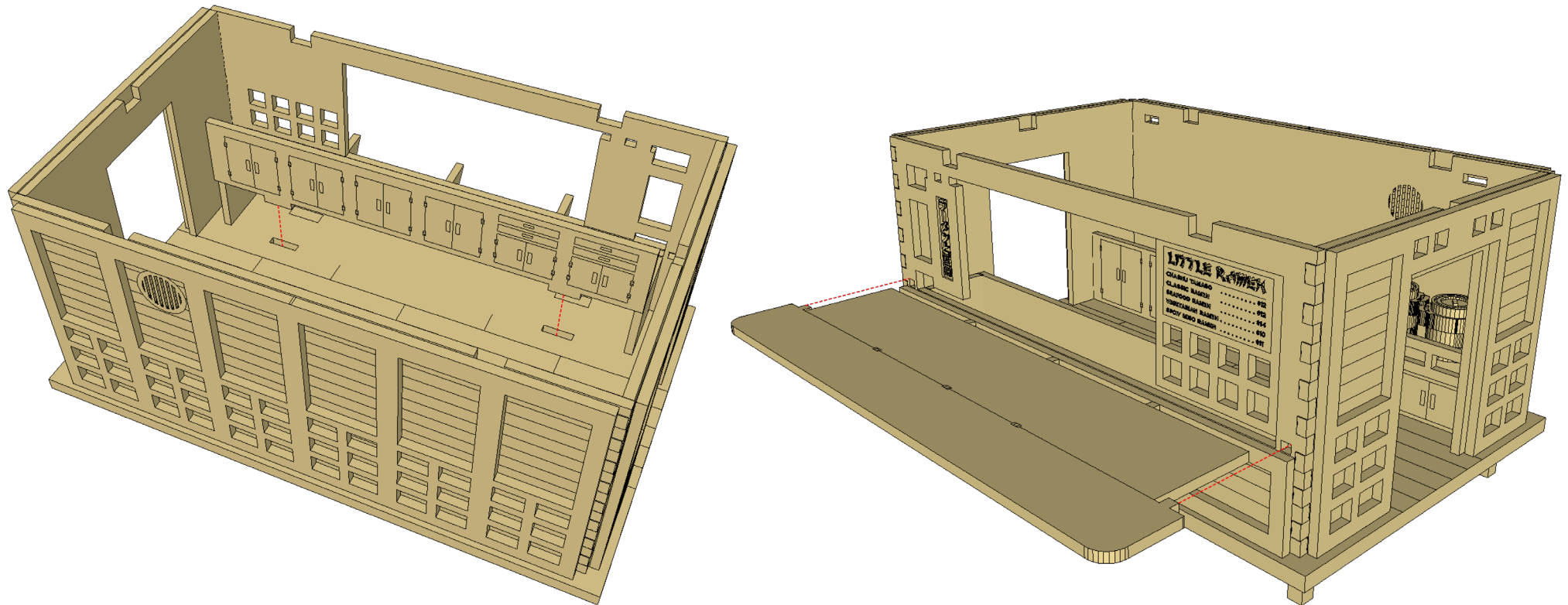

# LITTLE RAMEN ASSEMBLY INSTRUCTIONS

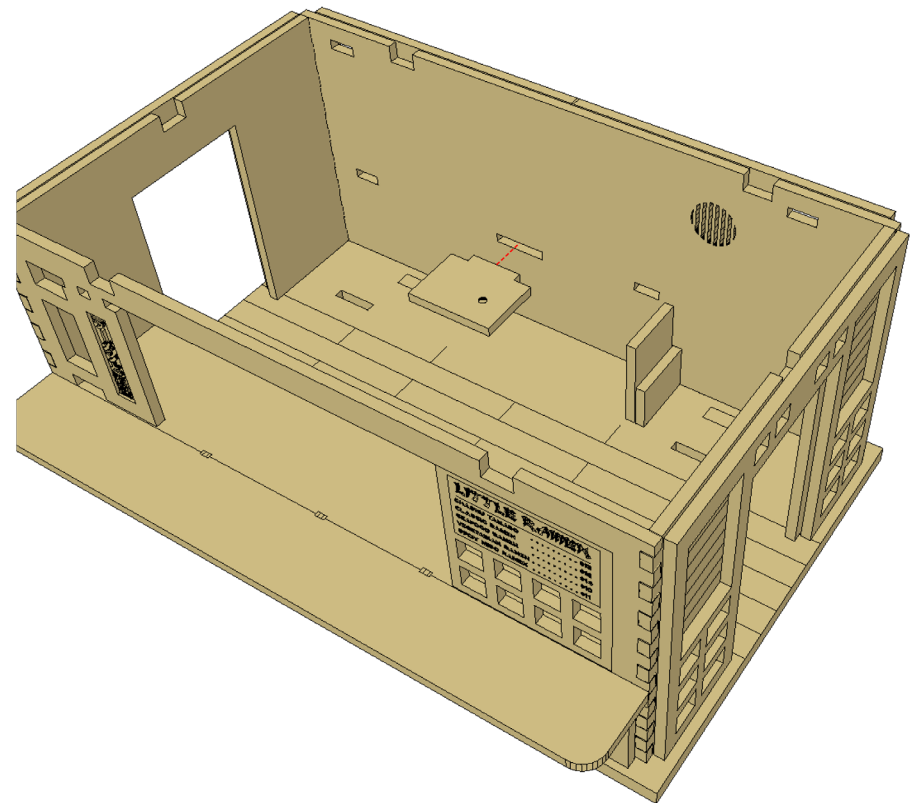
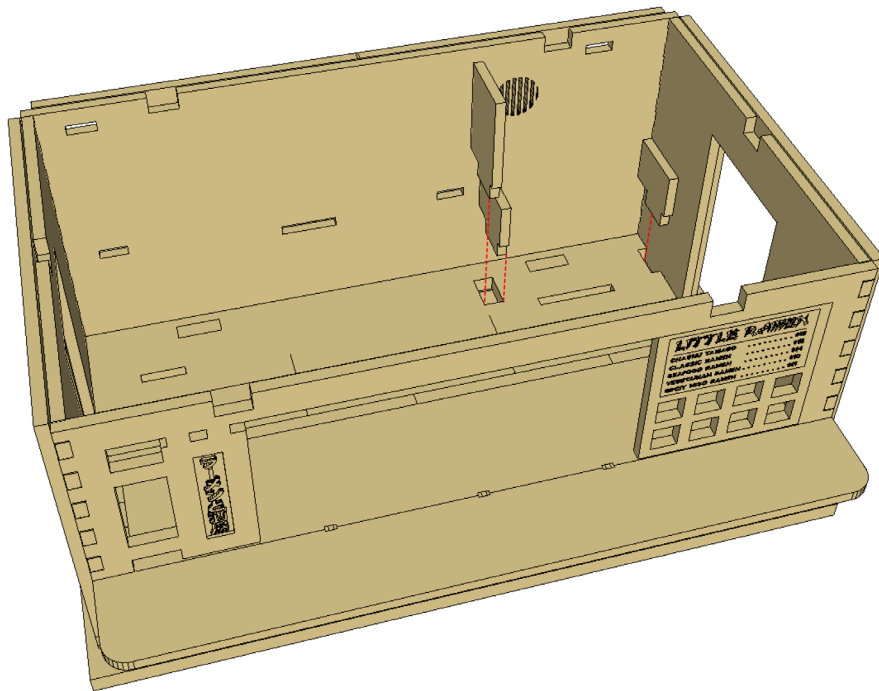

# LITTLE RAMEN ASSEMBLY INSTRUCTIONS

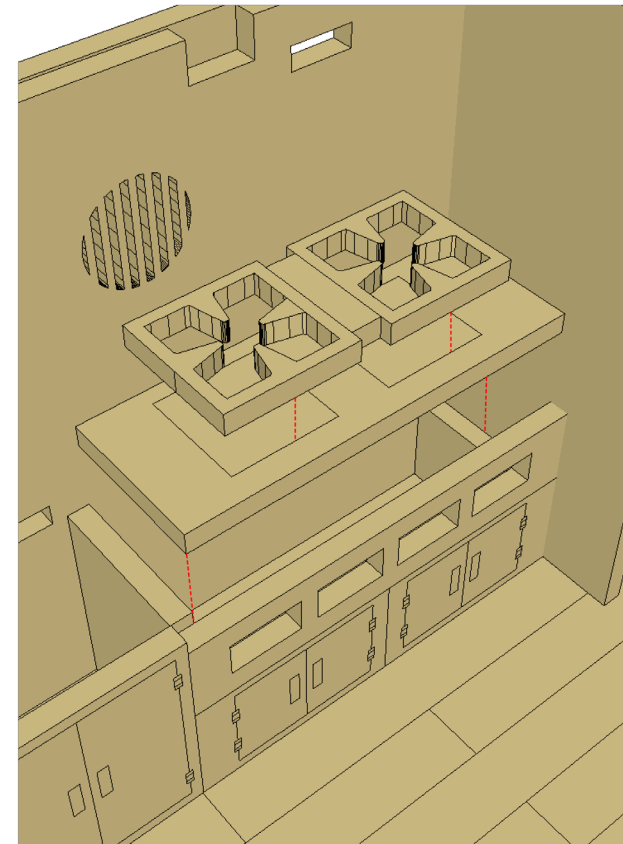
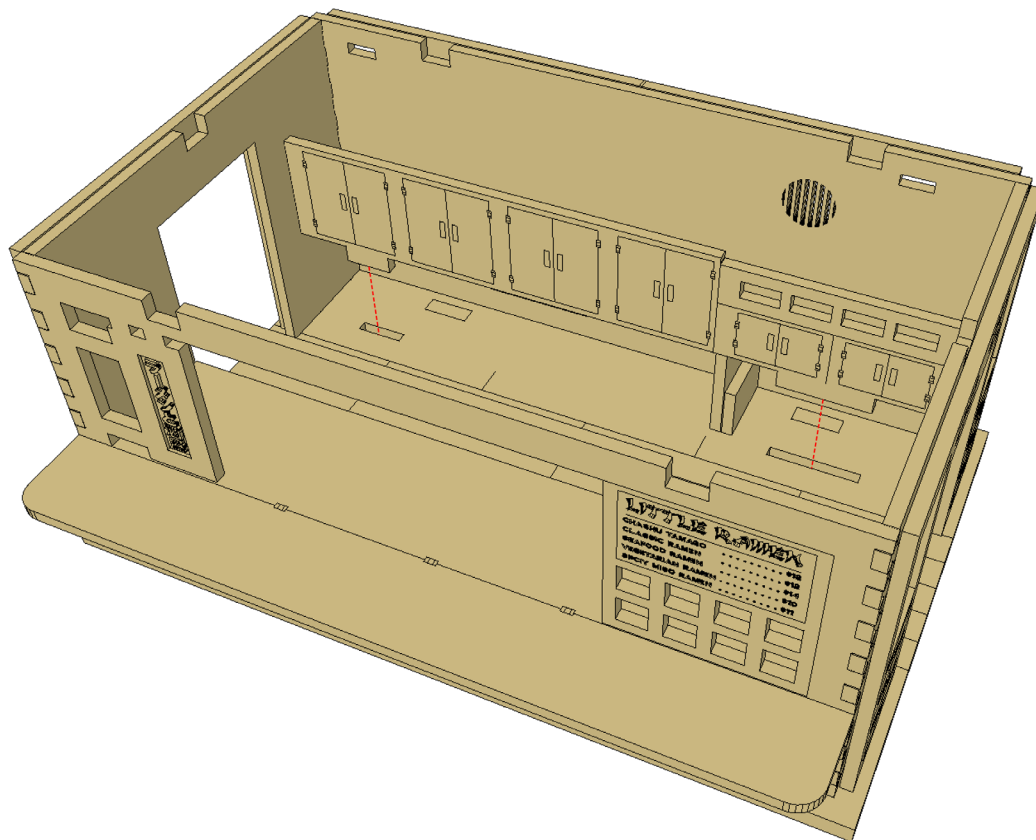

# LITTLE RAMEN ASSEMBLY INSTRUCTIONS

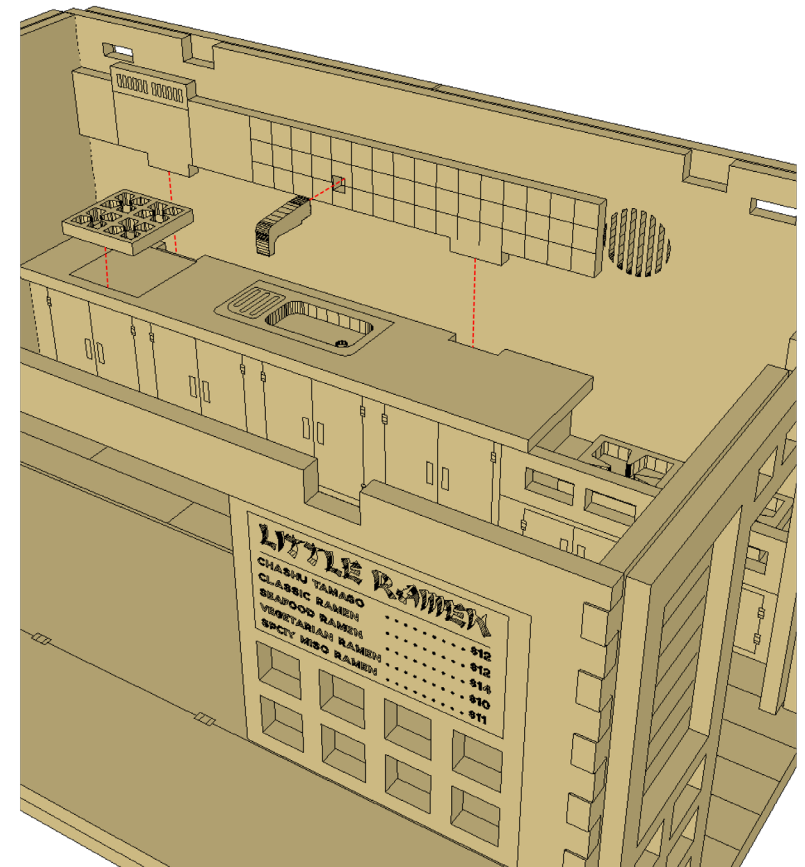
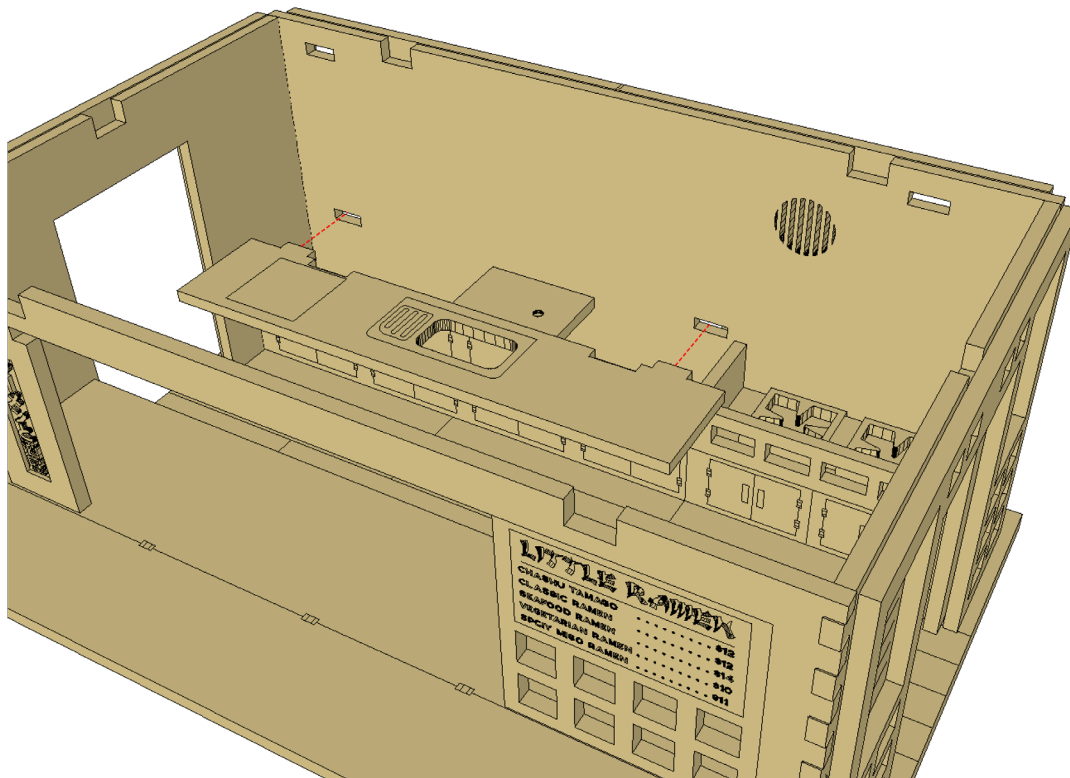

# LITTLE RAMEN ASSEMBLY INSTRUCTIONS

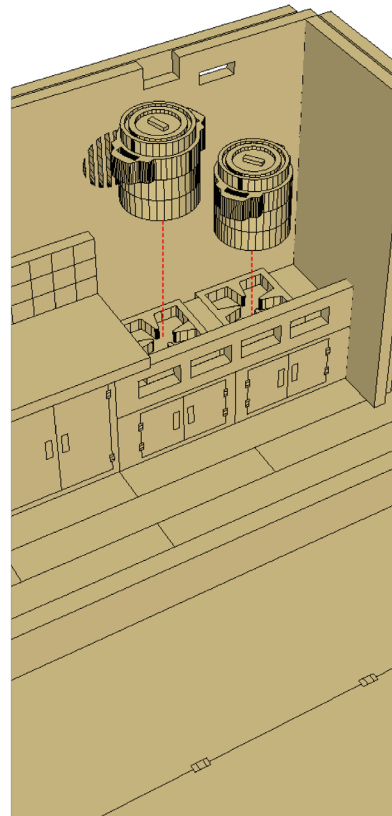
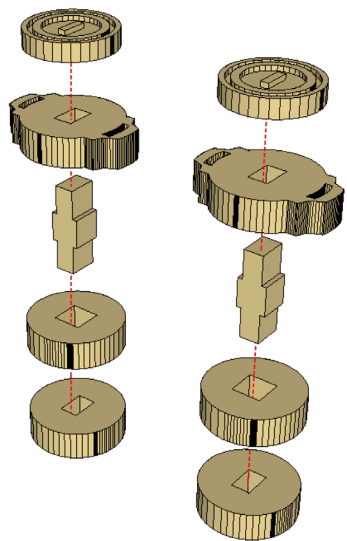

Line up the edges  
of the facade with  
the inner join of  
the base wall

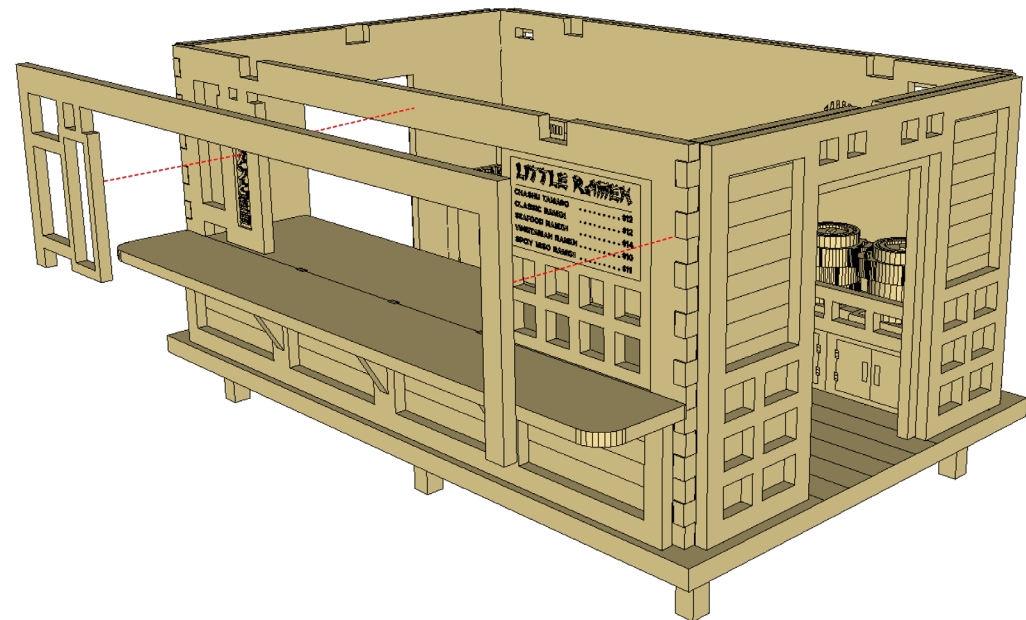

# LITTLE RAMEN ASSEMBLY INSTRUCTIONS

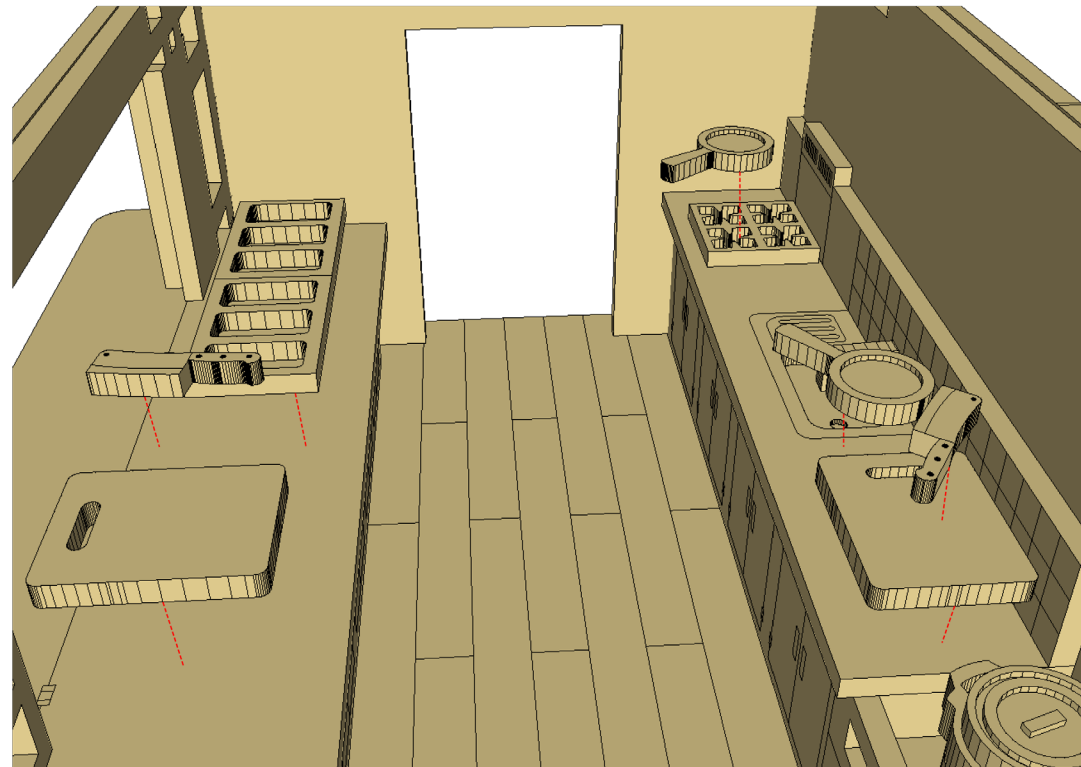
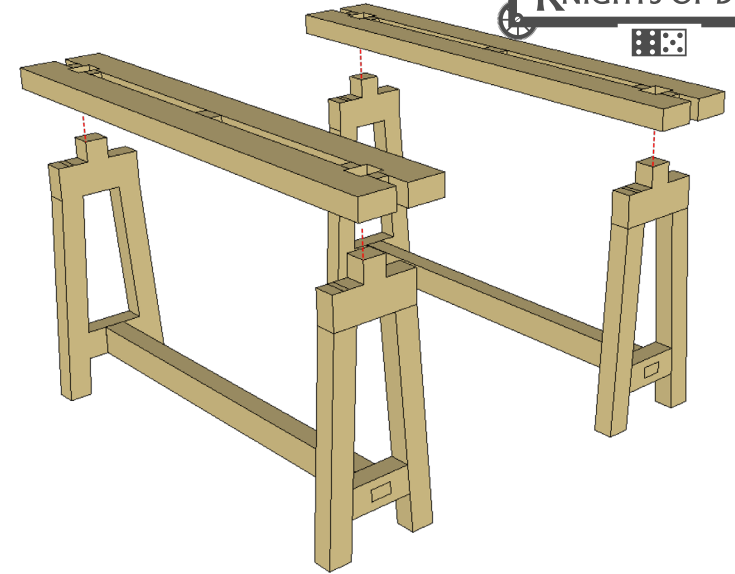
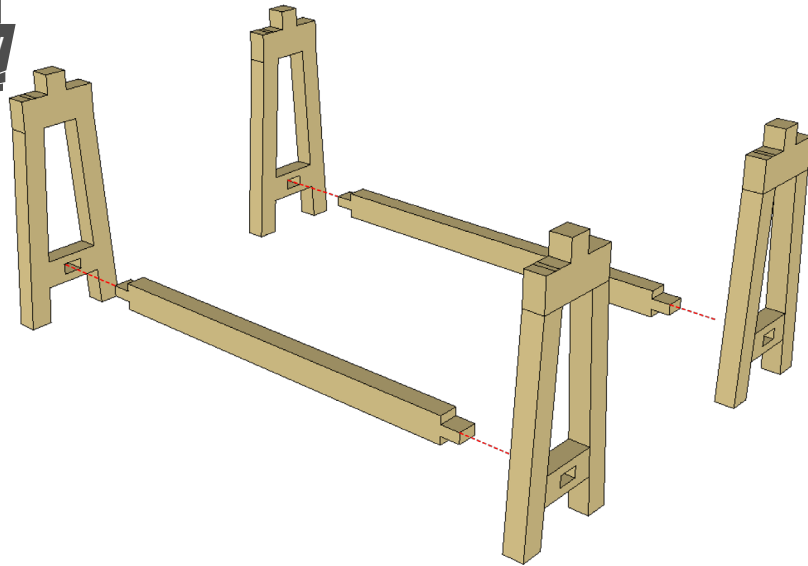

Place these loose  
accessories  
wherever you'd  
like

# LITTLE RAMEN ASSEMBLY INSTRUCTIONS

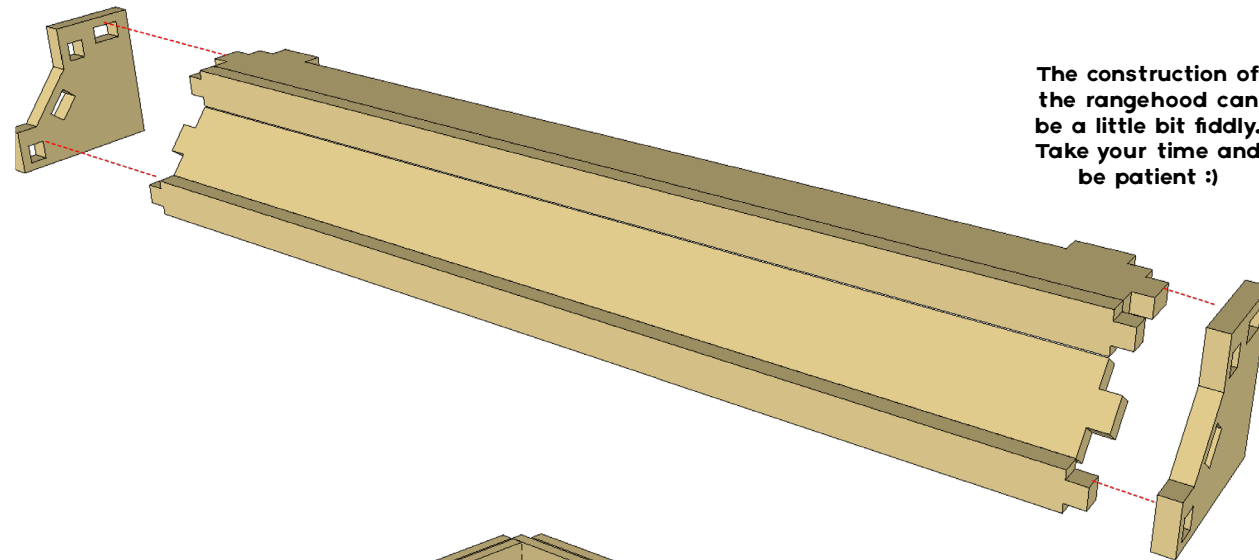

The construction of the rangehood can be a little bit fiddly. Take your time and be patient :)

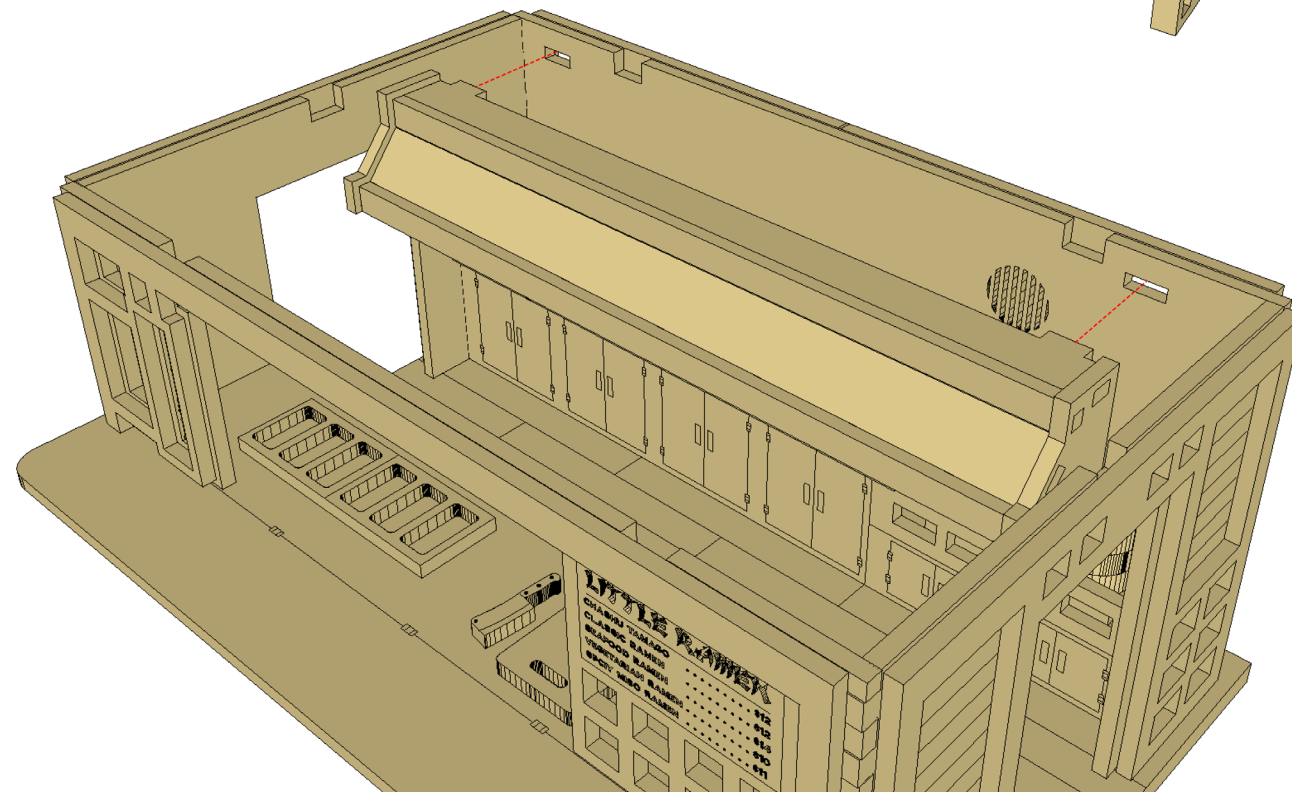

# LITTLE RAMEN ASSEMBLY INSTRUCTIONS

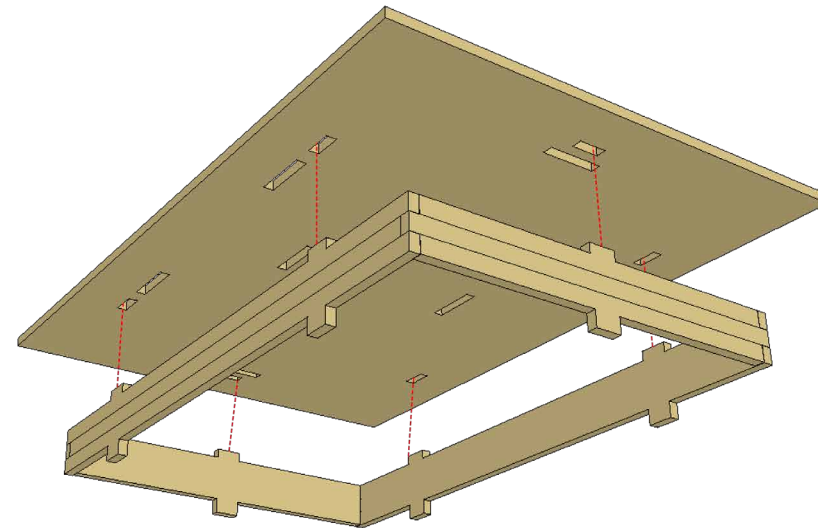
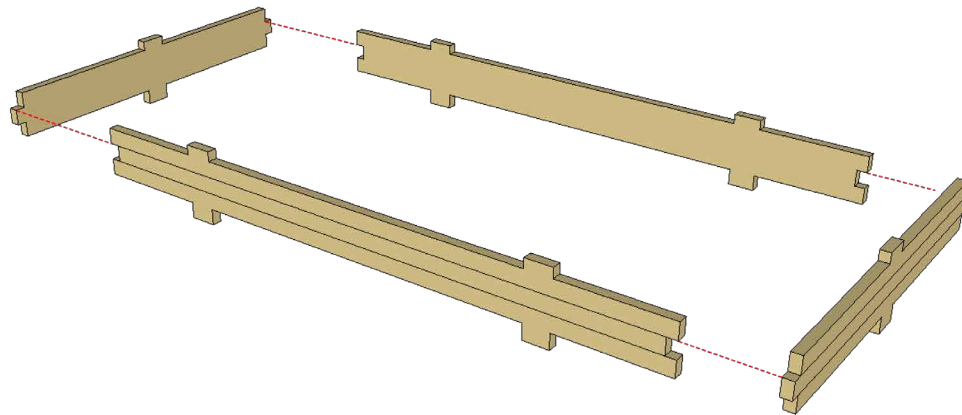

# LITTLE RAMEN ASSEMBLY INSTRUCTIONS

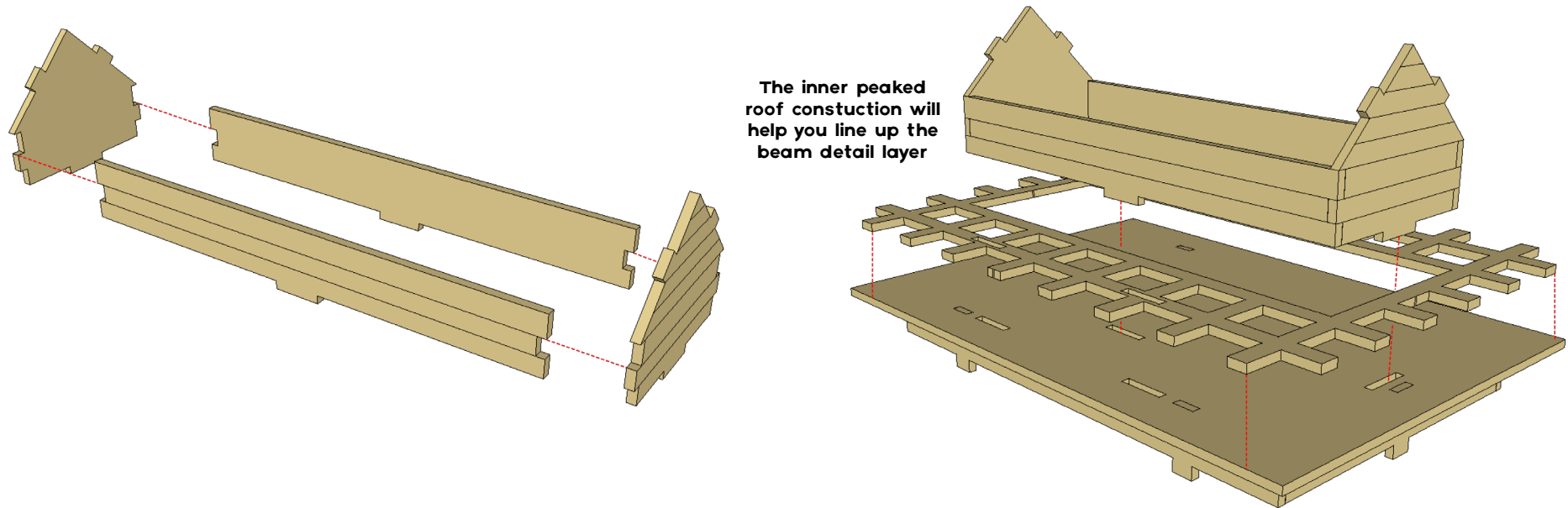

## LITTLE RAMEN ASSEMBLY INSTRUCTIONS

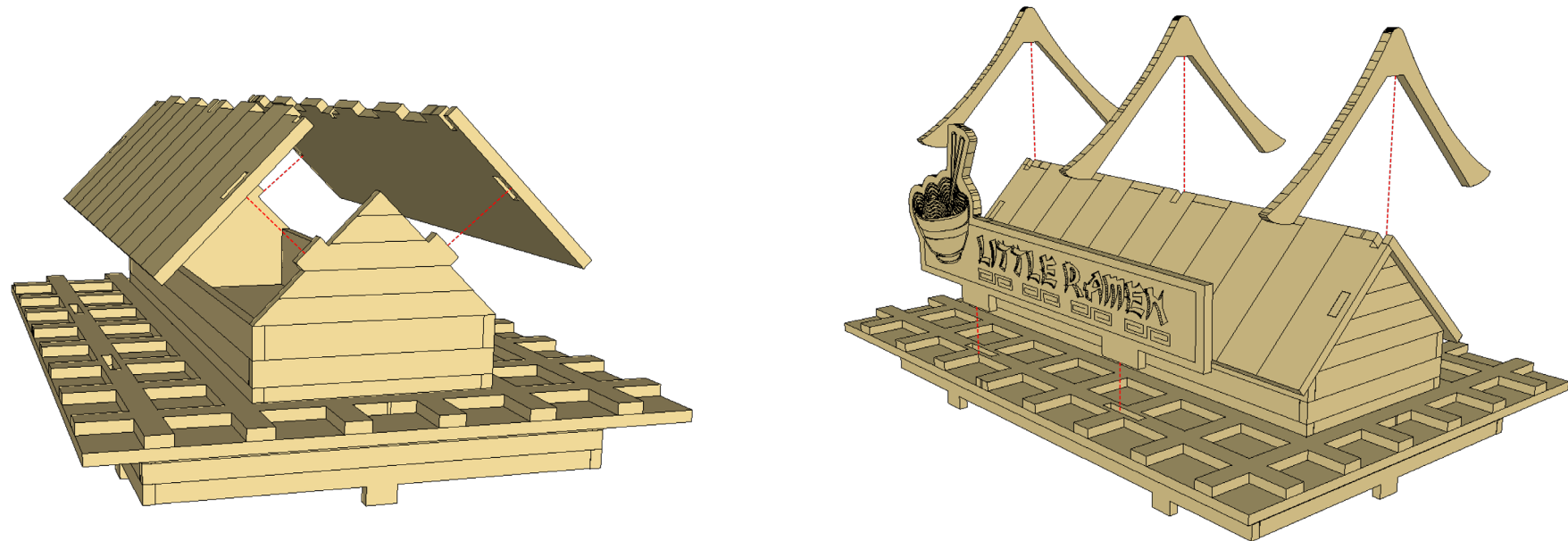

# LITTLE RAMEN ASSEMBLY INSTRUCTIONS



Don't glue your roof in place,  
you want to be able to  
access that highly detailed  
interior :)

