

RAINBOW KARAOKE

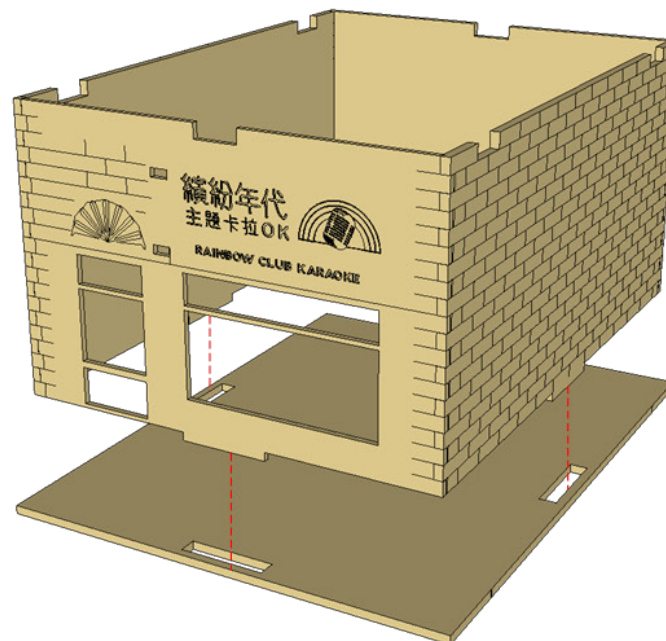

RAINBOW KARAOKE

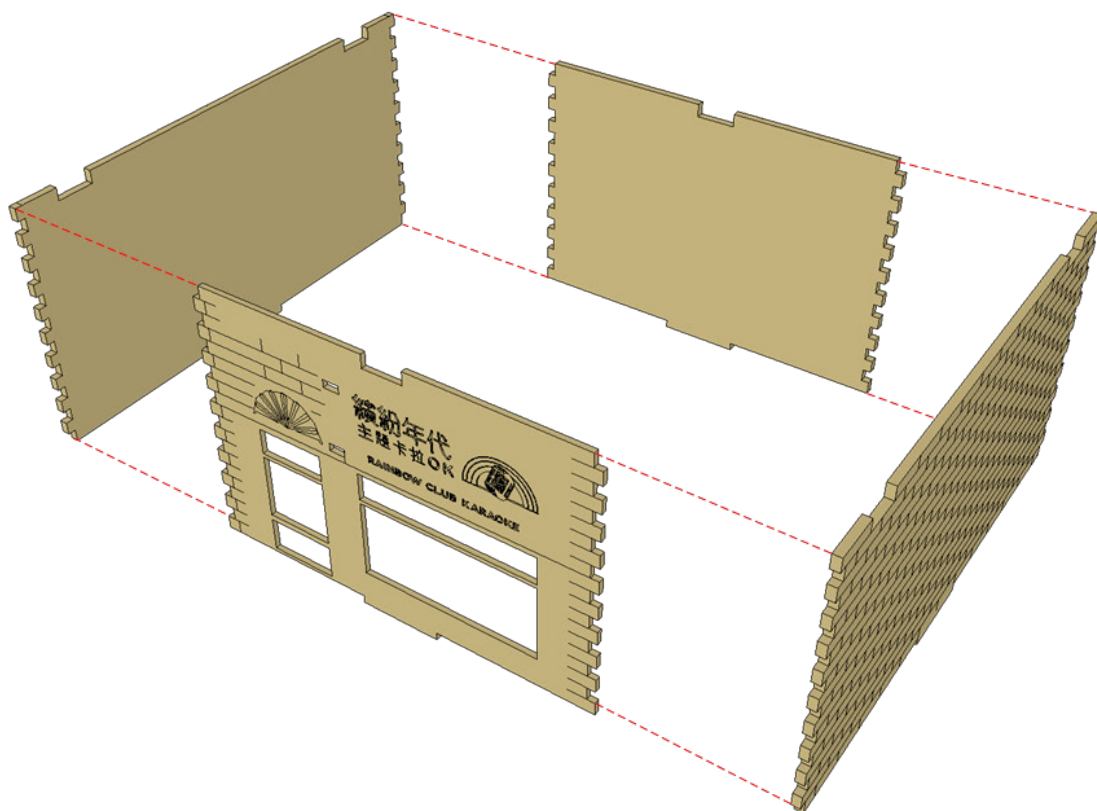
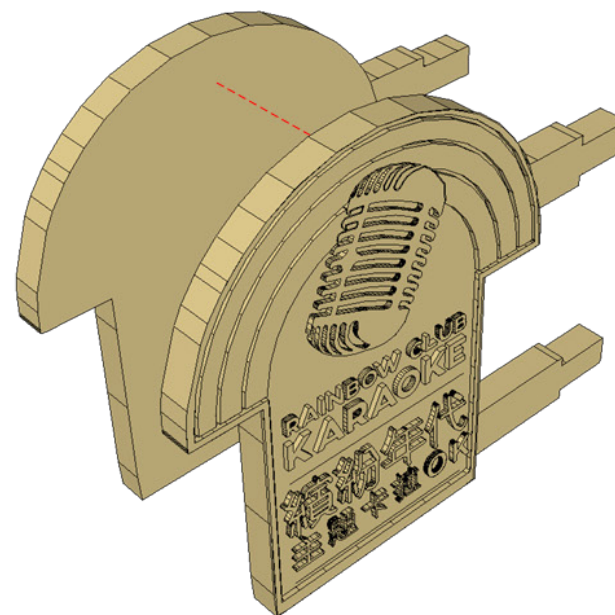
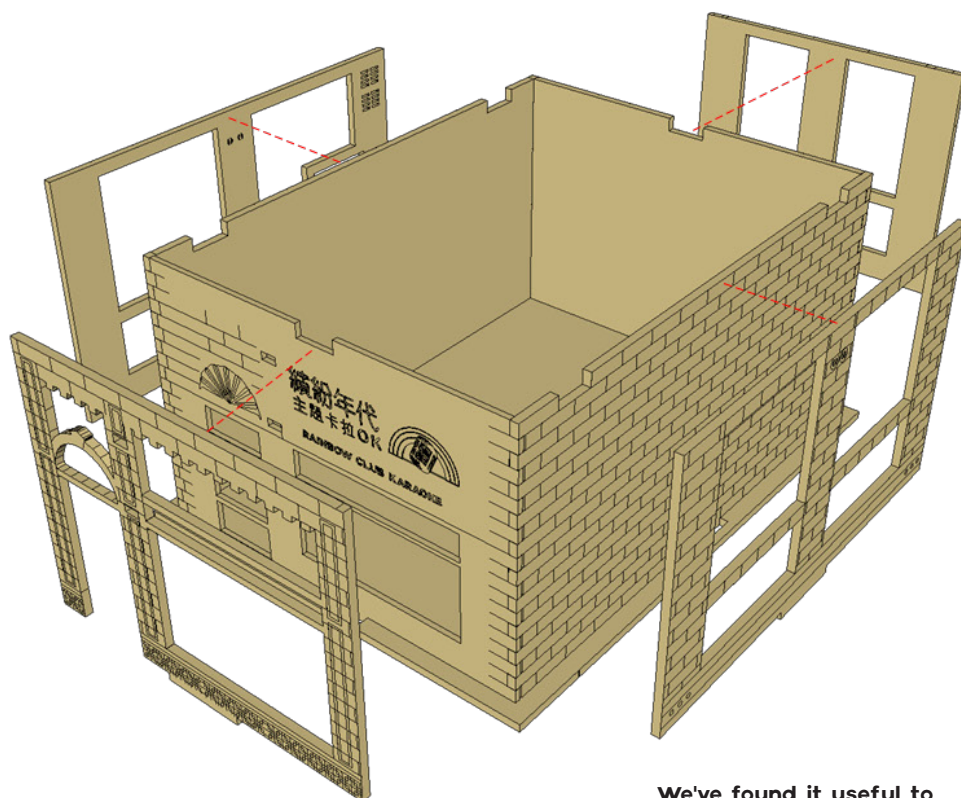

We've found it useful to
Apply glue to the facade pieces, then slot
them into the holes on the base piece.
Make sure you have the correct facade
piece for the correct side (as some side
have doors and corresponding facades).
Small clamps or large elastic bands also
help with securing the facade pieces
while they dry

RAINBOW KARAOKE

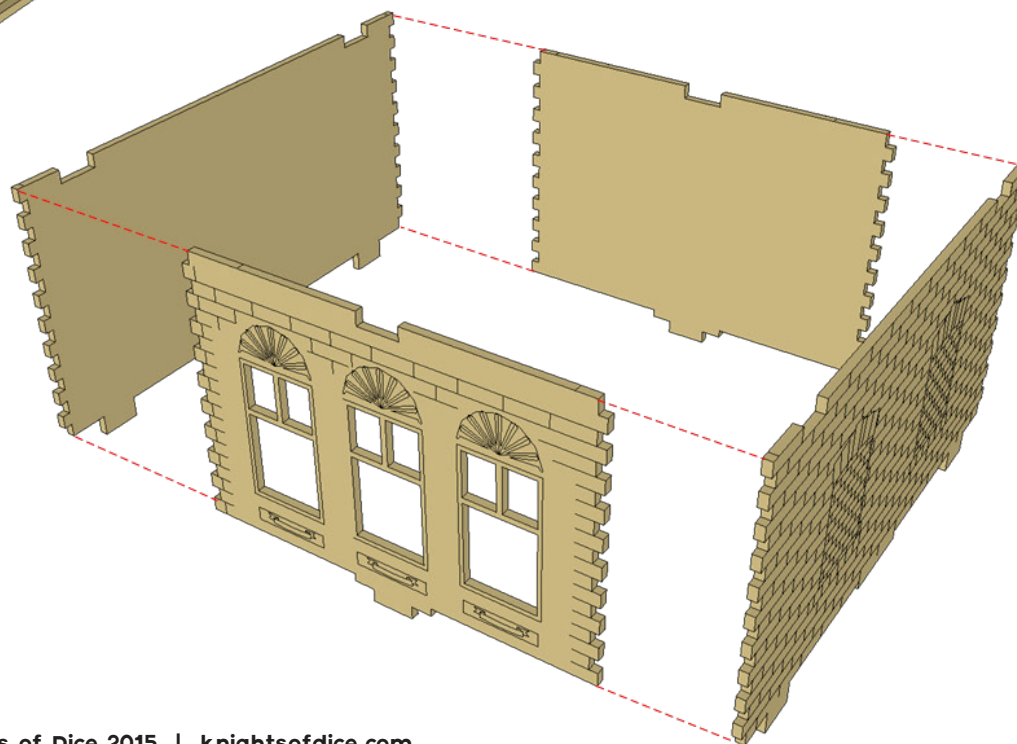
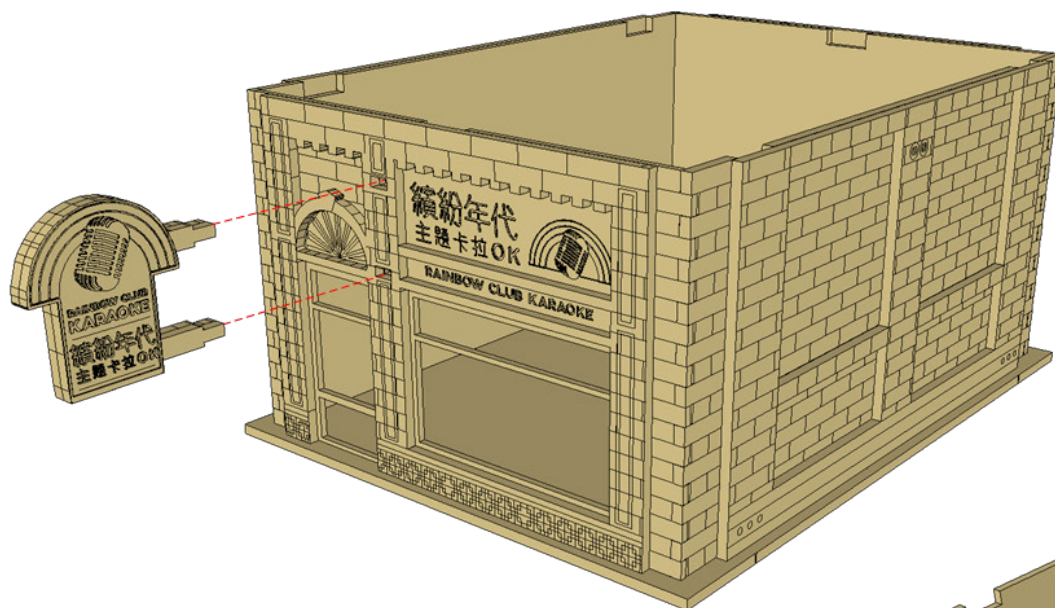

RAINBOW KARAOKE

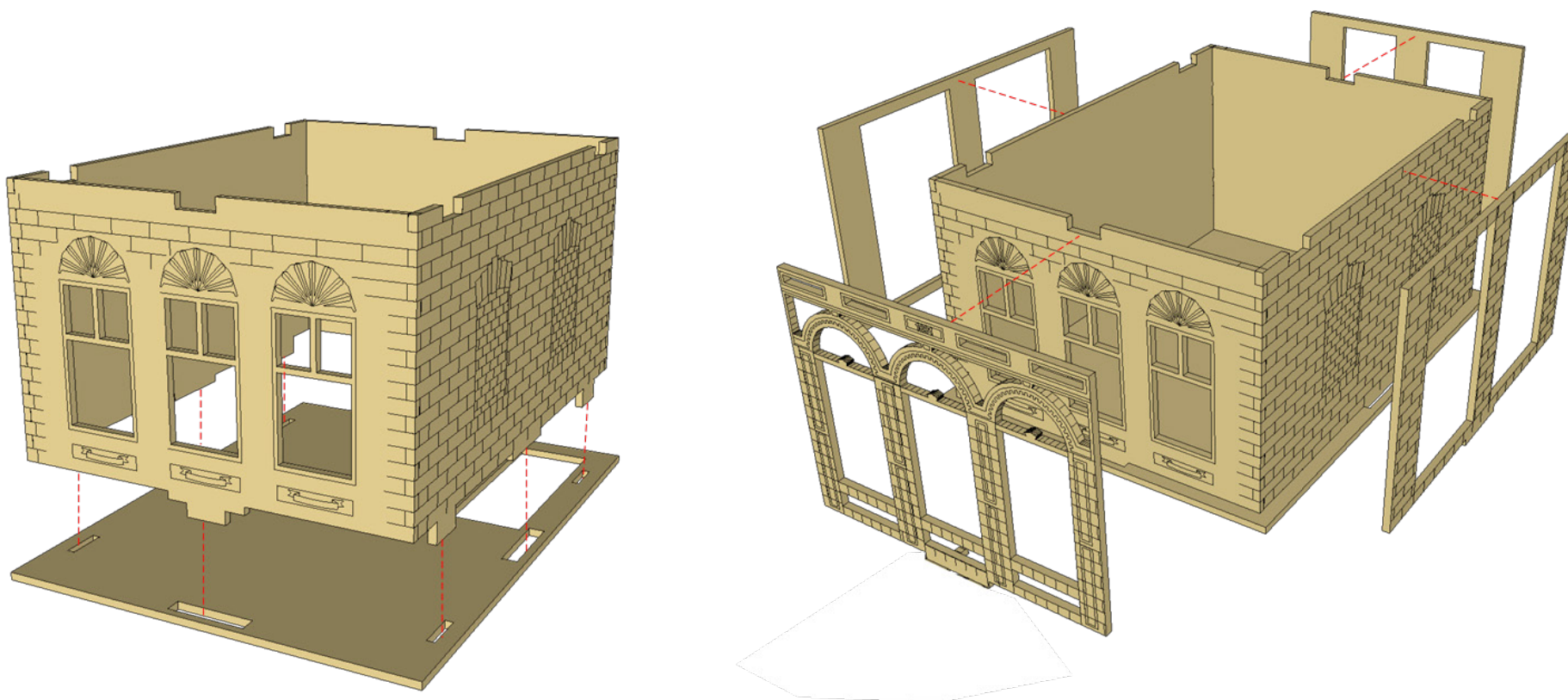

RAINBOW KARAOKE

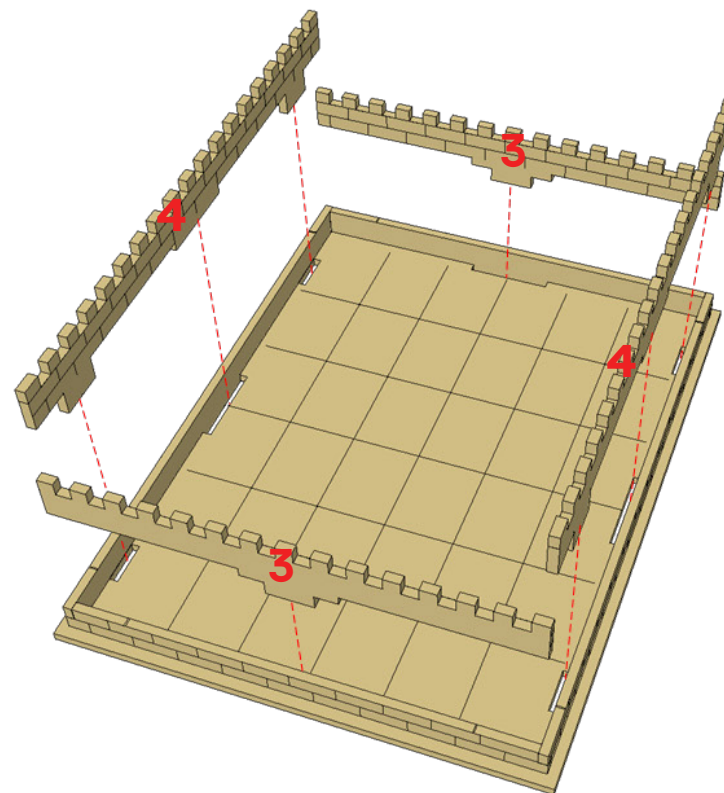
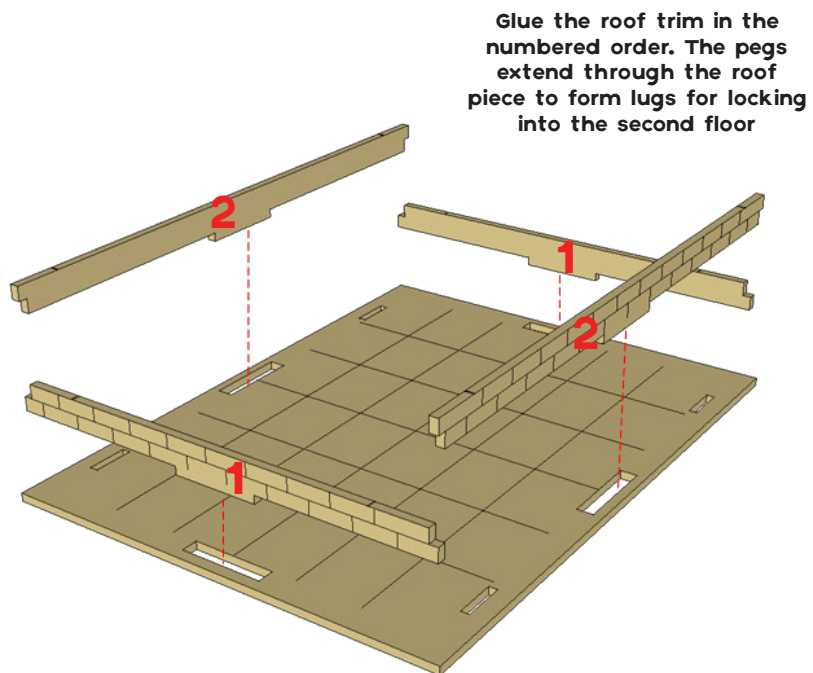

RAINBOW KARAOKE

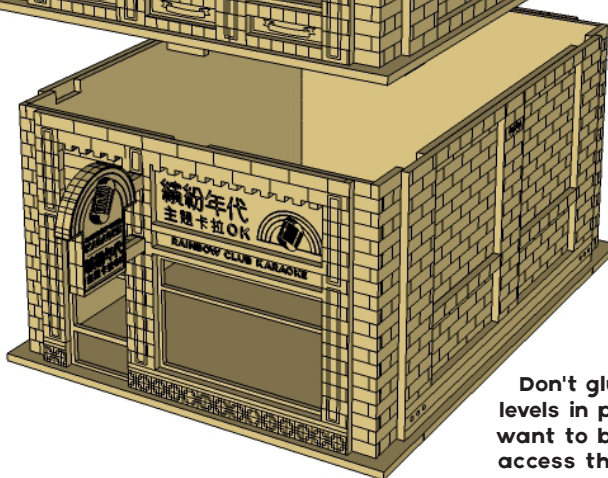
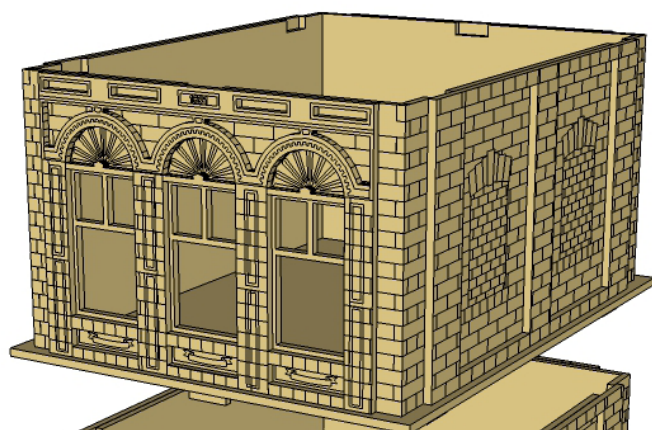
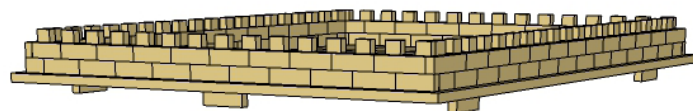

Don't glue your levels in place, you want to be able to access the interior

