

## ARGON'S WORKSHOP INSTRUCTIONS

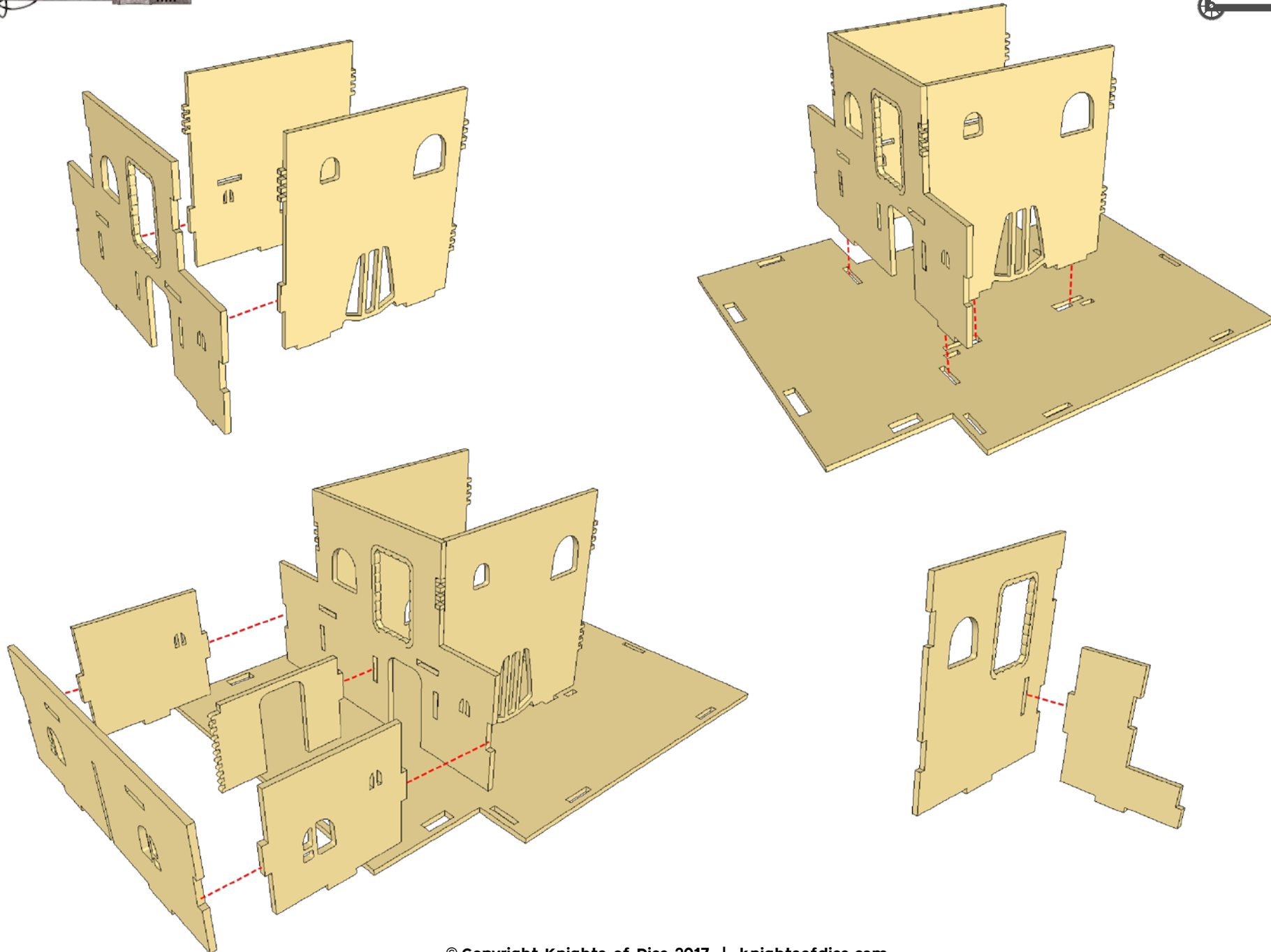

## ARGON'S WORKSHOP INSTRUCTIONS

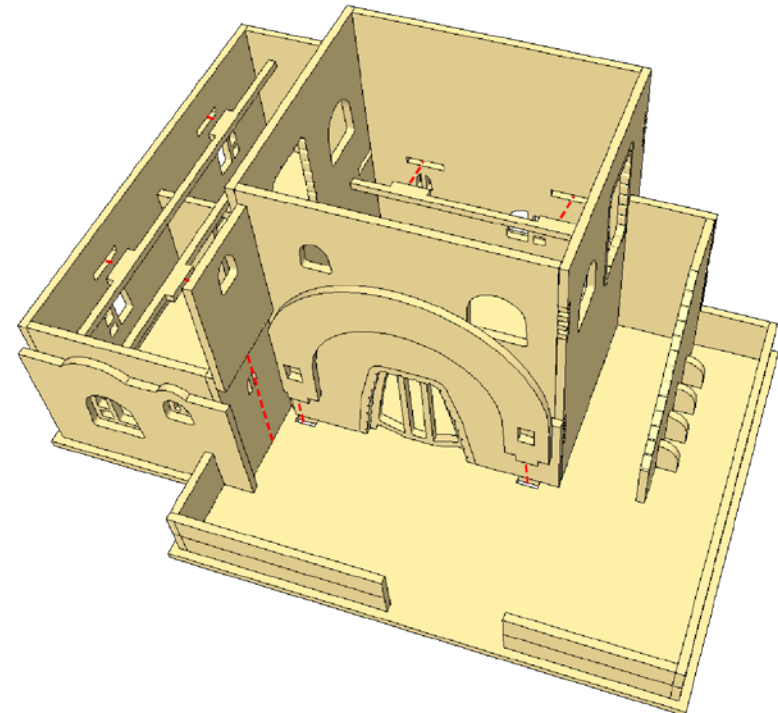
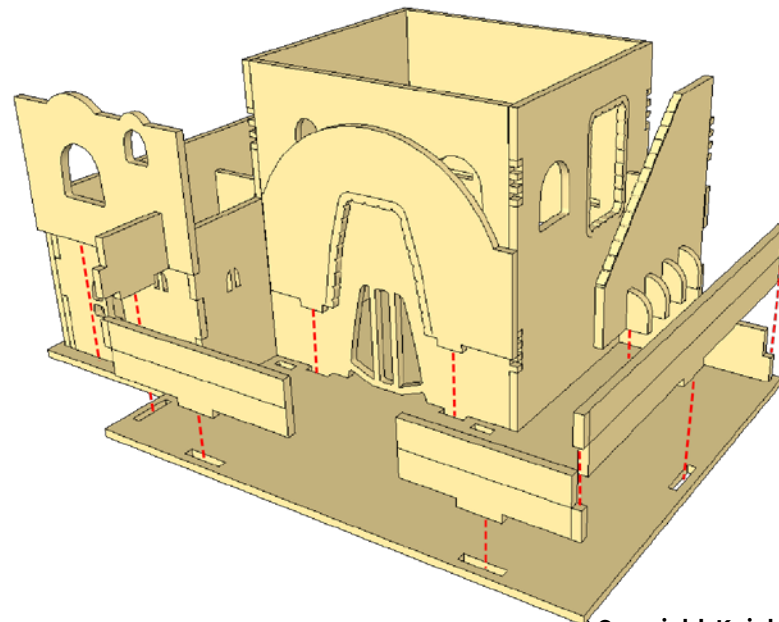
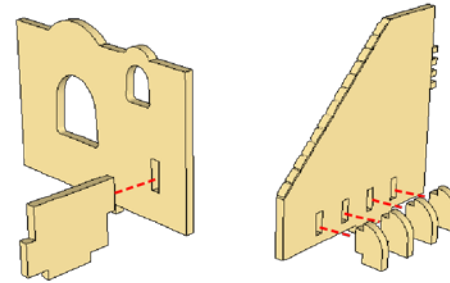
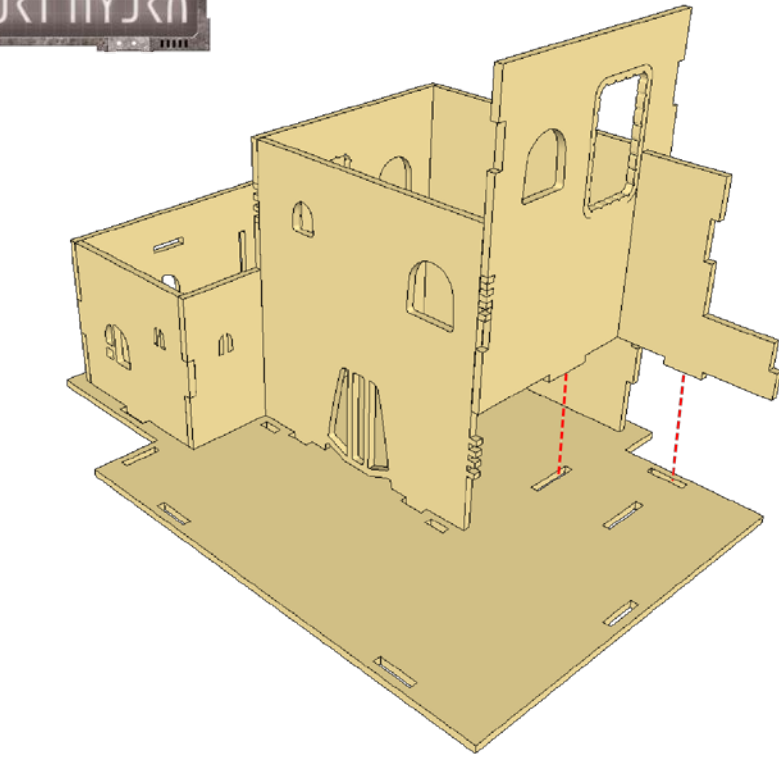

# ARGON'S WORKSHOP INSTRUCTIONS

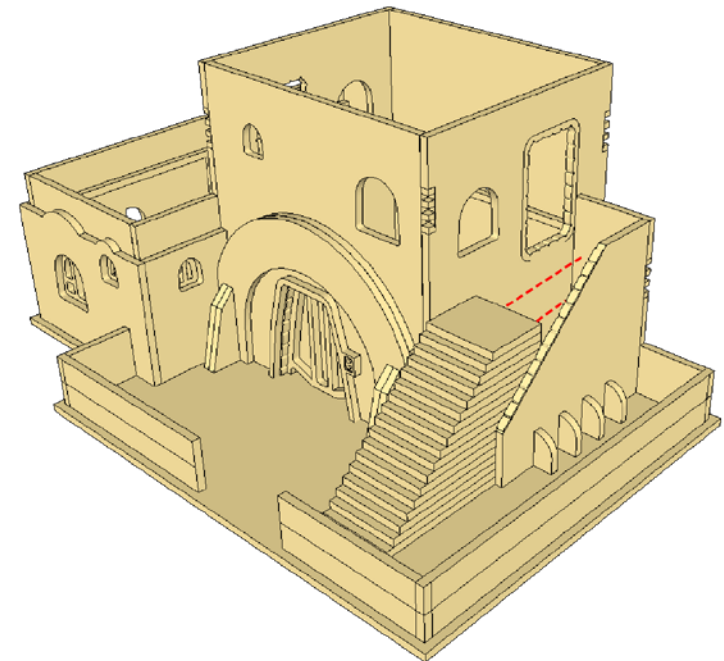
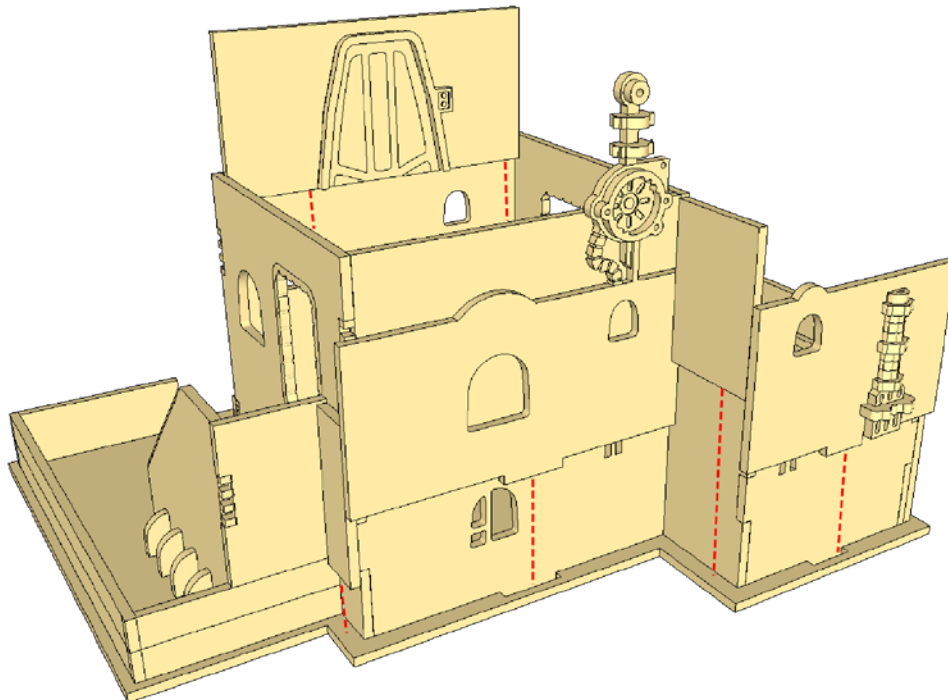
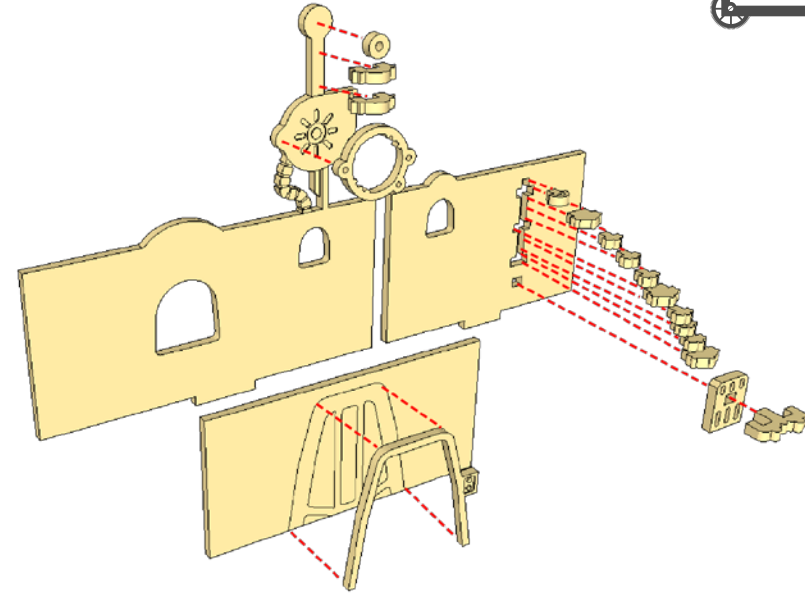
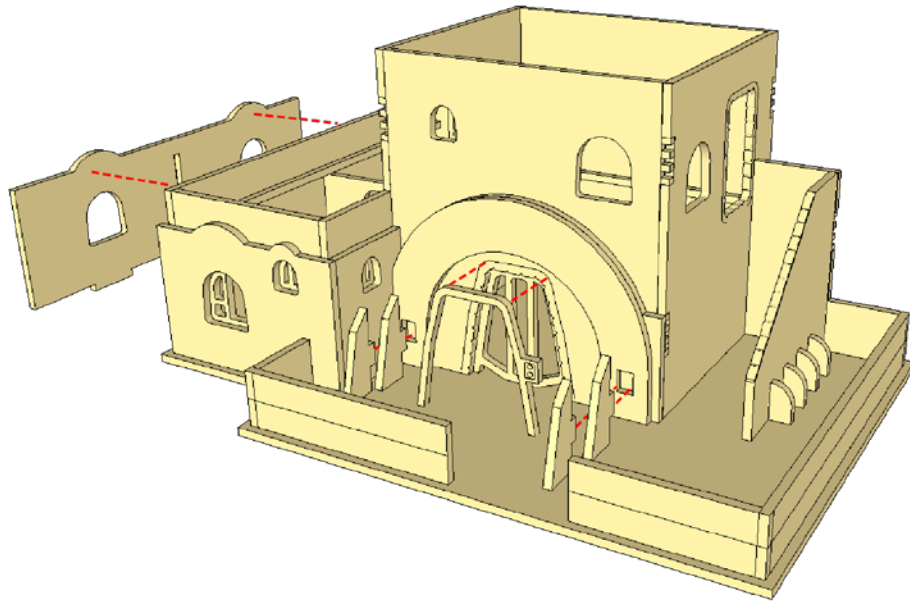

## ARGON'S WORKSHOP INSTRUCTIONS

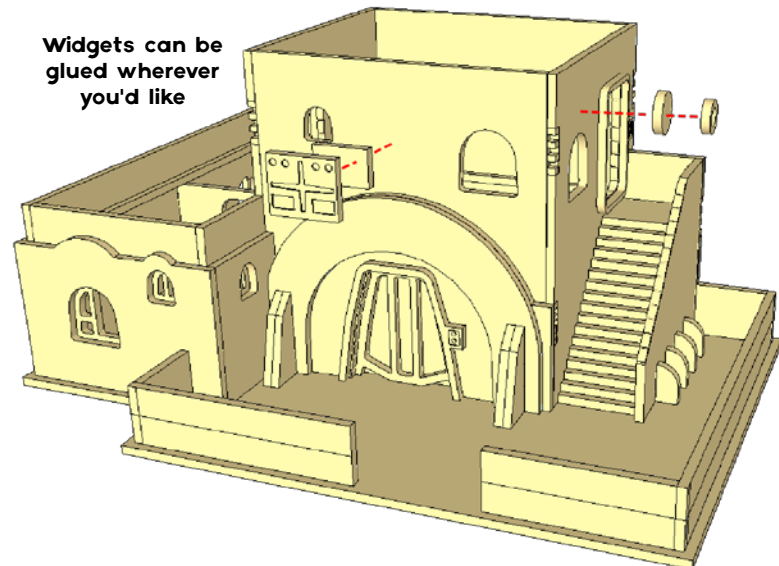
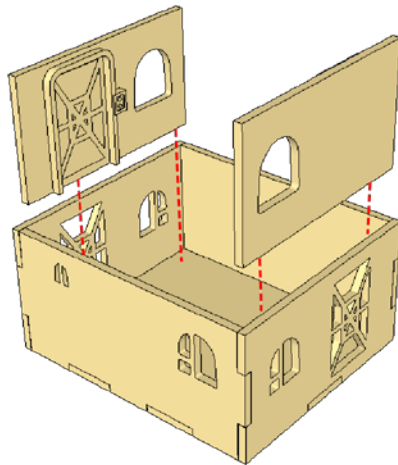
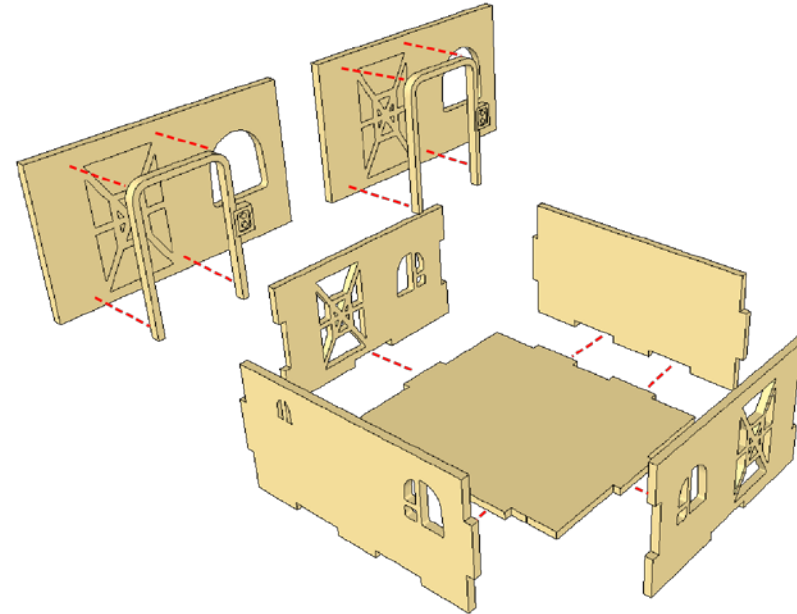
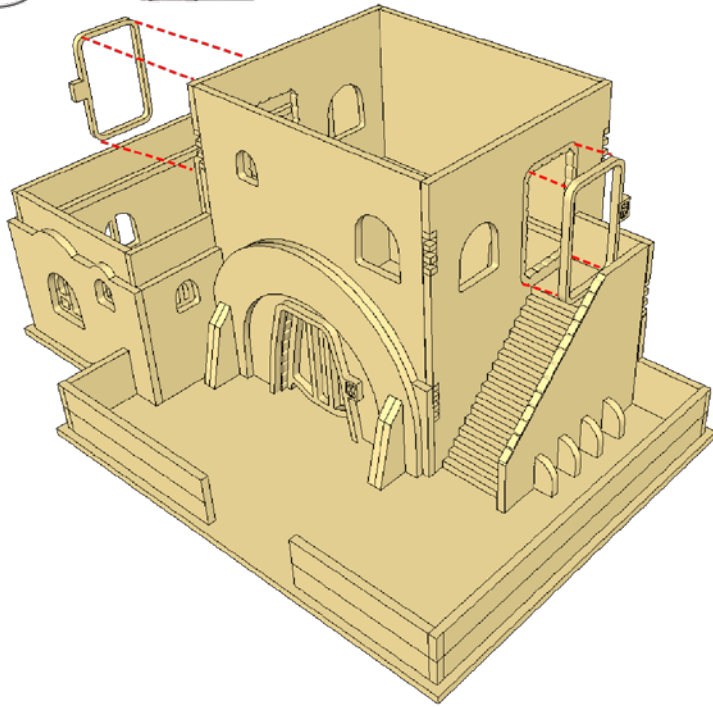



## ARGON'S WORKSHOP INSTRUCTIONS

The top storey room is a "basket" that can be removed for access to the ground floor

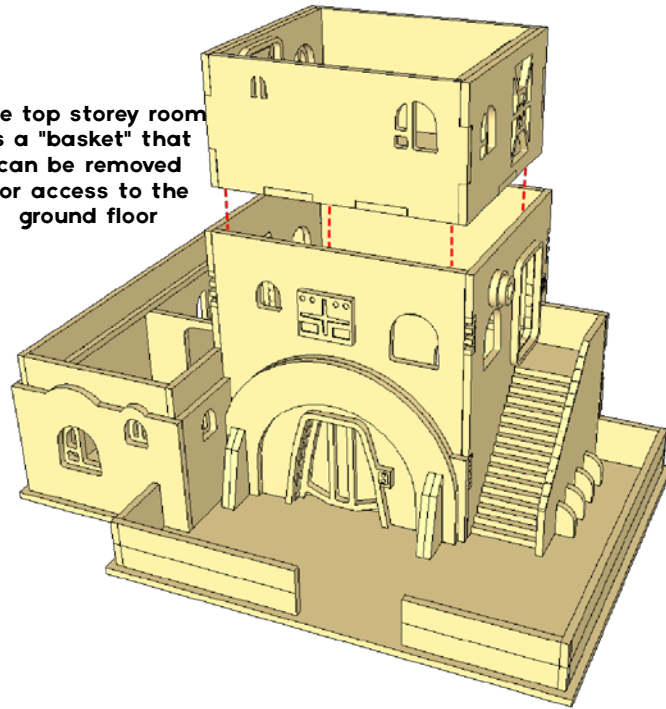

Roofs are designed to be removable for interior access

