

WOLFMAN PLAZA ASSEMBLY INSTRUCTIONS

If you wish to place a backing material behind your windows (a good suggestion that we have used is reflective foil card, available from art and stationary stores), do not glue the base in place at this time, wait until after painting the main building. You will still need to slot the base in place to assist with the gluing of the facade pieces however.

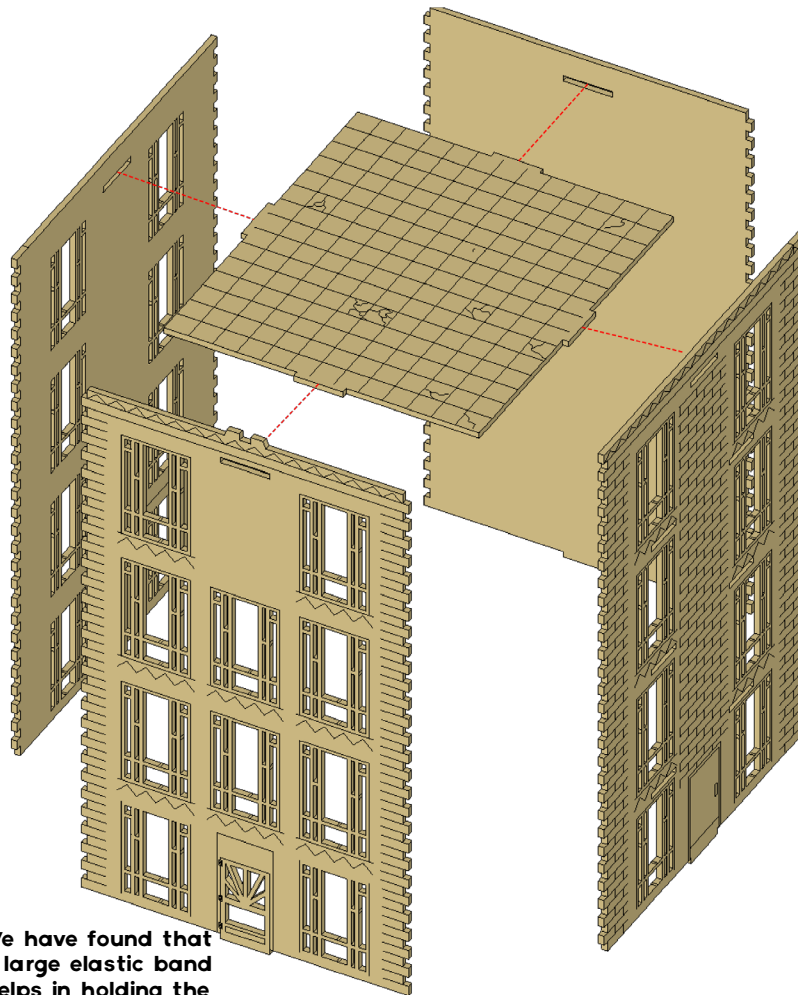

We have found that a large elastic band helps in holding the building together at this stage for drying

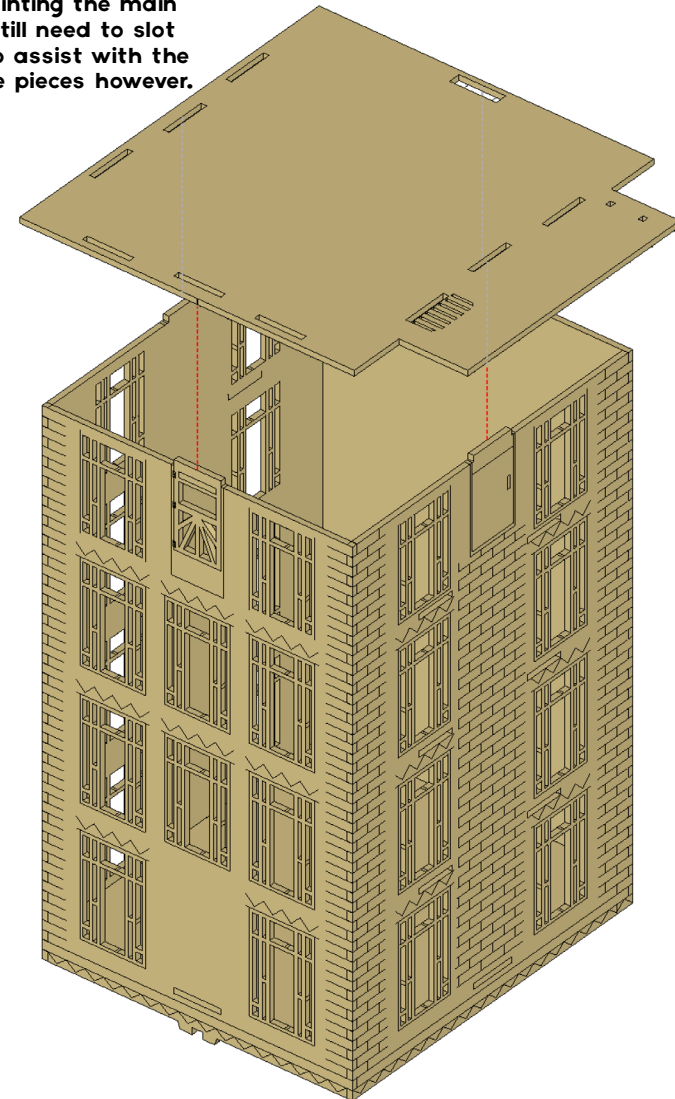



WOLFMAN PLAZA ASSEMBLY INSTRUCTIONS



We've found it useful to
Apply glue to the facade pieces, then slot
them into the holes on the base piece.
Make sure you have the correct facade
piece for the correct side (as some side
have doors and corresponding facades).
Small clamps or large elastic bands also
help with securing the facade pieces
while they dry

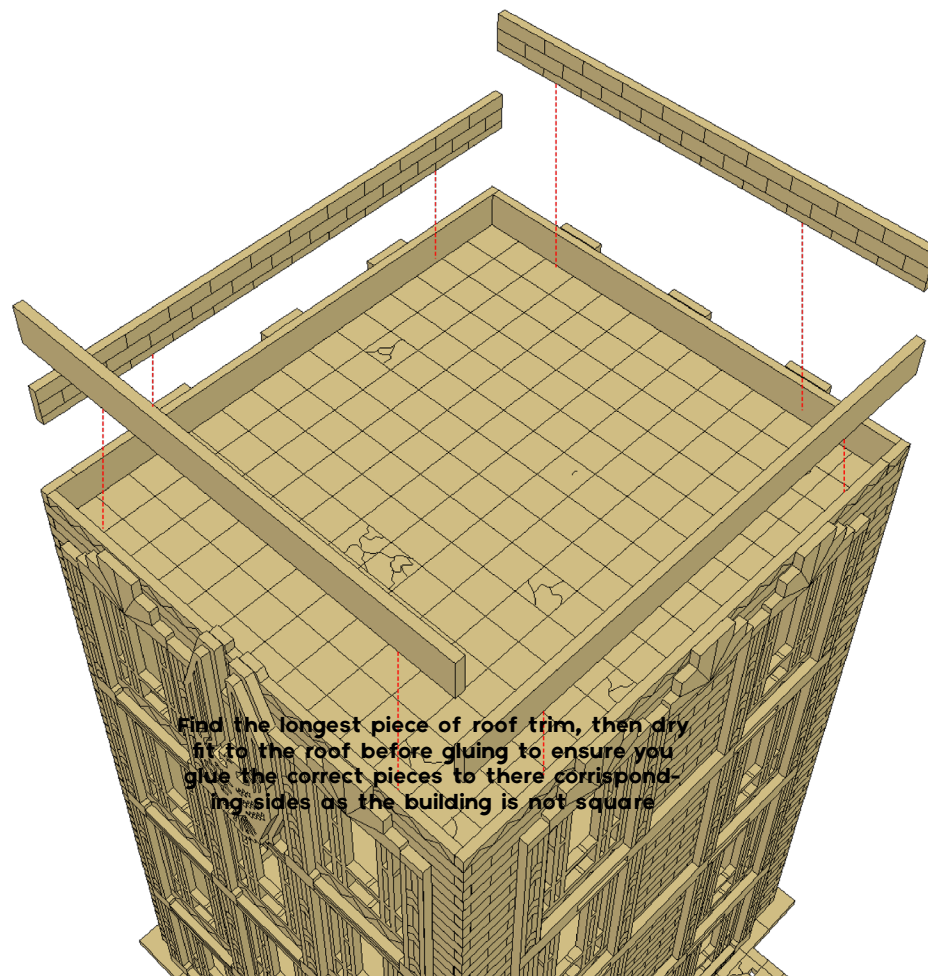
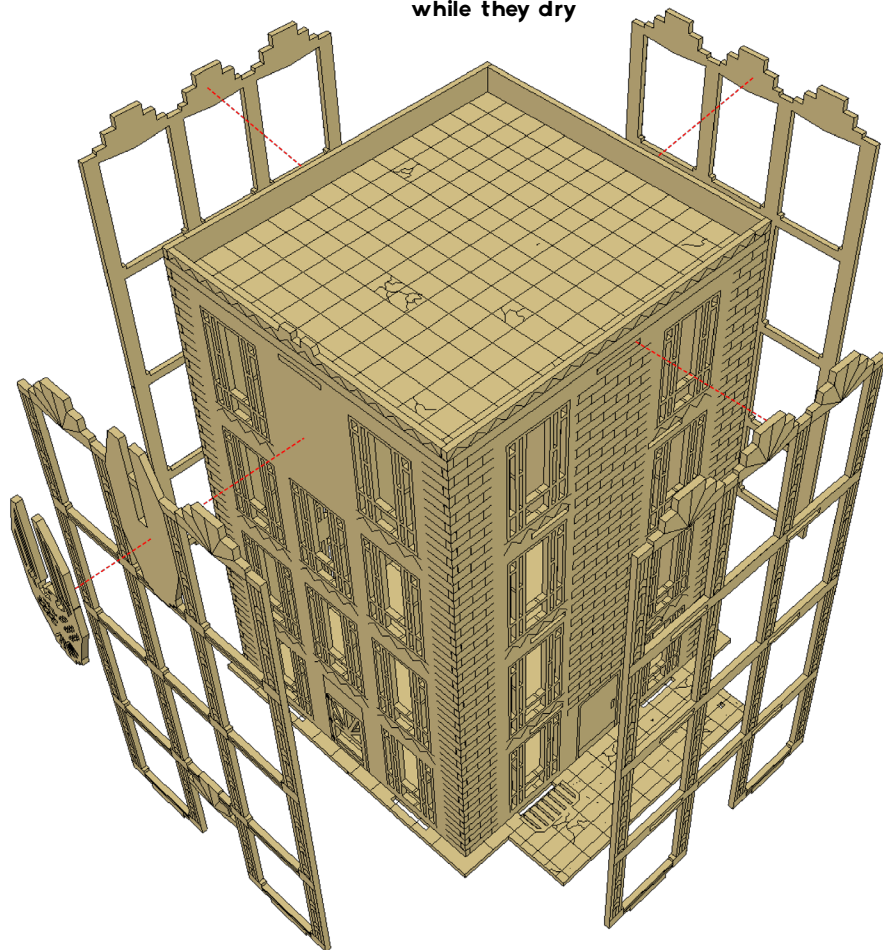

Find the longest piece of roof trim, then dry
fit to the roof before gluing to ensure you
glue the correct pieces to there correspond-
ing sides as the building is not square

WOLFMAN PLAZA ASSEMBLY INSTRUCTIONS

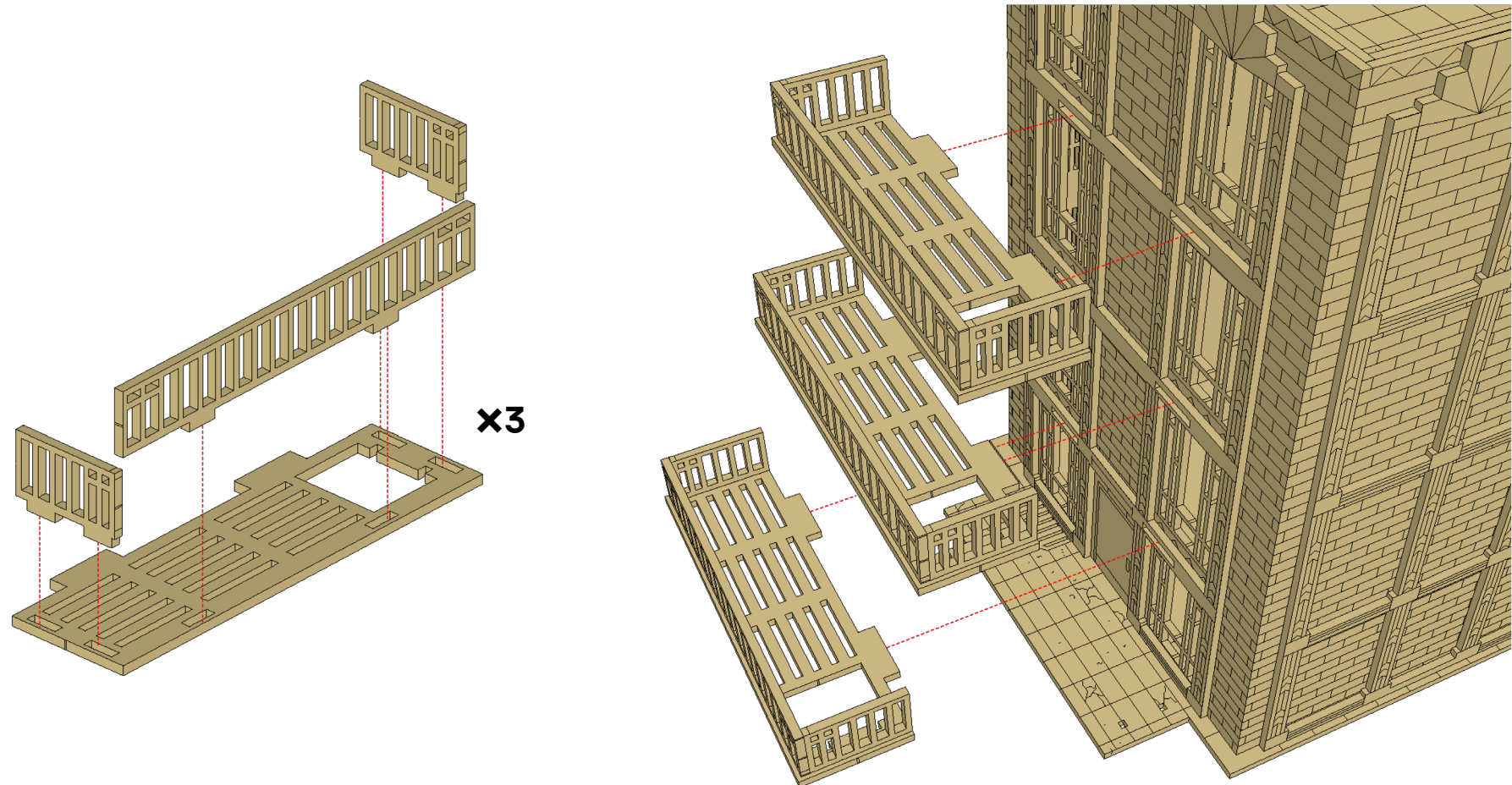

WOLFMAN PLAZA ASSEMBLY INSTRUCTIONS

The ladder only goes in one way: you'll notice that the gaps between one of the rungs is smaller than the others, this rung should be positioned toward the bottom of the ladder (on the first floor fire escape). Make sure to dry fit the ladder first to make sure you have the orientation right

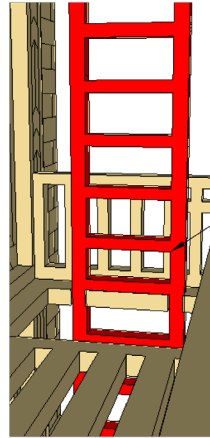

• SMALL RUNG

